

## DATA SHEET

### Electromagnetic Lock with Door Status Sensor, Force 180Kg



EM-180-S

- Model: EM-180-S
- Holding Force: 180 Kg
- Operating Voltage: 12 VDC/300mA | 24 VDC/165mA
- With a door status sensor
- Safety for people: Door opens when power fails
- Anodized aluminium box
- Galvanized steel magnets
- Size: 170x37x21 mm
- Operating temperature: -10 ~+55°C (14-131F)

## Dimension

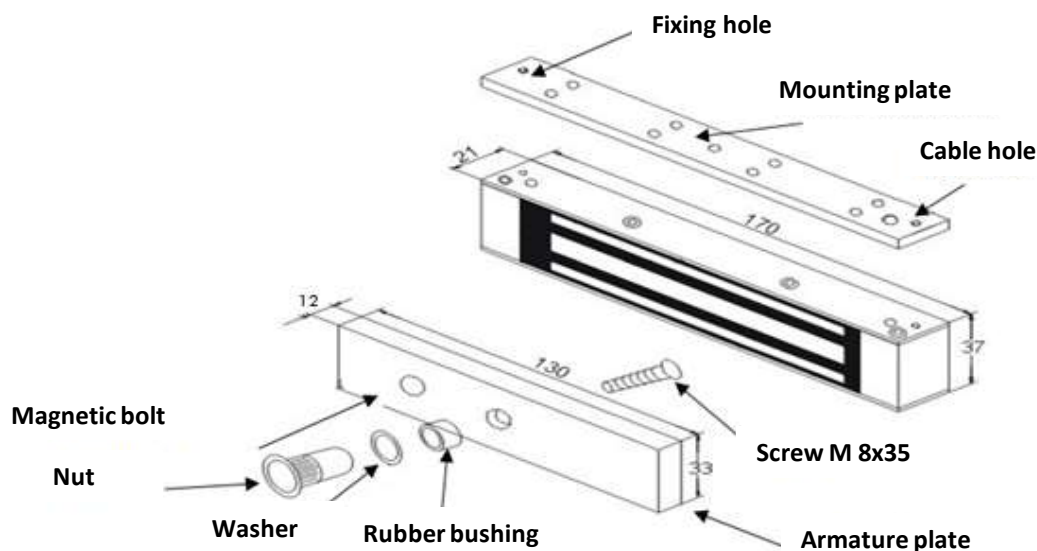



## Installation

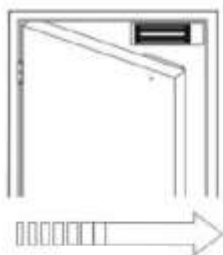

Steps

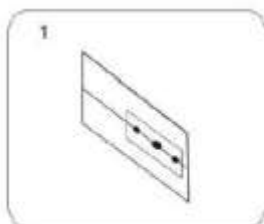

Template

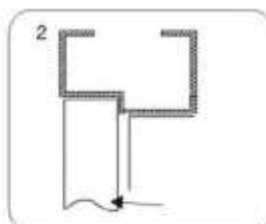

Close the door, place the template on the frame

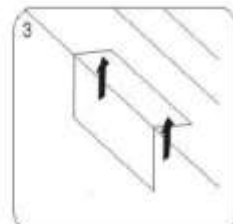

Draw the holes on the frame and on the door

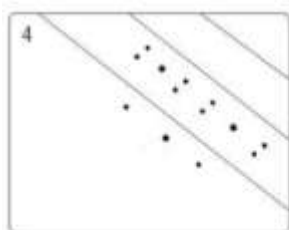

Drill with the right bore

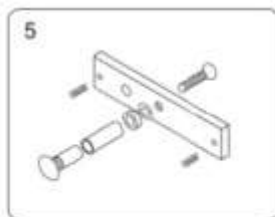

Install the armature plate on the door wing

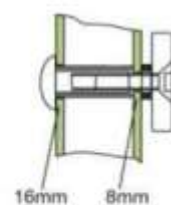

Metallic whole  
Int. hole 8mm  
Ext. hole 16mm

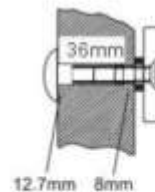

Wood  
Int. hole 8mm  
Ext. hole 13mm



Plated  
Int. hole 8mm

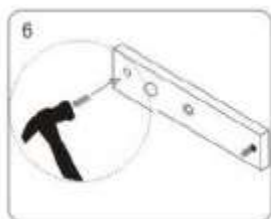

Place bolts in the armature plate

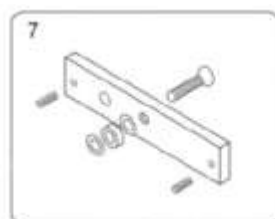

Place washers in the armature plate according to the design

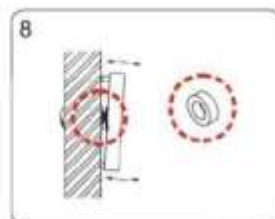

Place washers between the armature plate and door

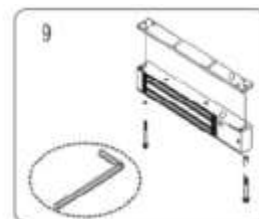

Use the hex key to remove the mounting plate

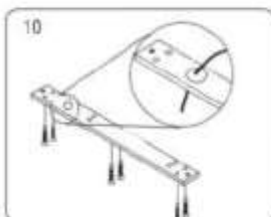

Pass cable through the hole and tighten the plate to the door frame

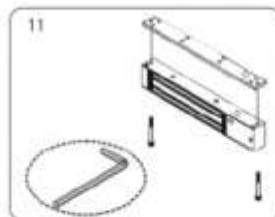

Tighten lock body to the plate

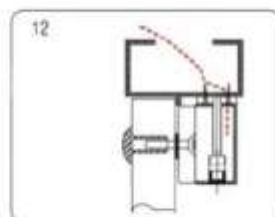

Close and pull door to test pulling force

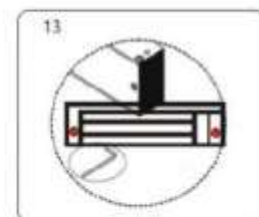

Tighten back fixing screws





## Bracket Installation

### L-Shaped Bracket

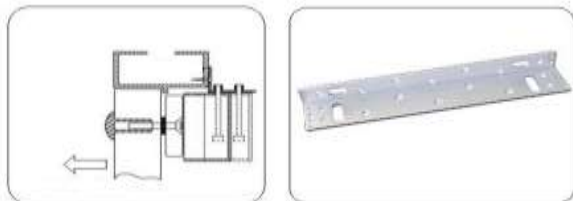

When door frame is less than 42 mm or door opens up outwards, is necessary to install a L-shaped bracket

### ZL-Shaped Bracket

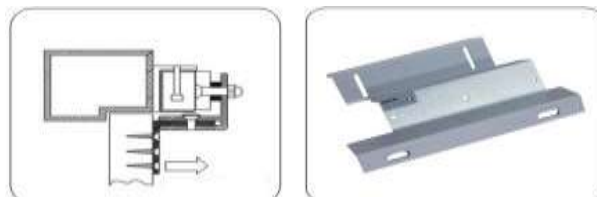

When door opens up inwards is necessary to install a ZL-shaped bracket

### U-Shaped Bracket

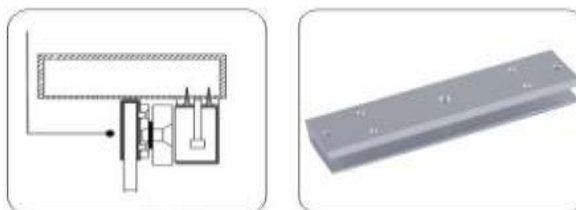

For 10 to 15 mm tempered glass doors is necessary to install a U-shaped bracket

## Installation Instructions



Straight Fixing

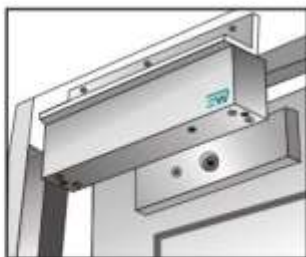

L-Shaped Bracket

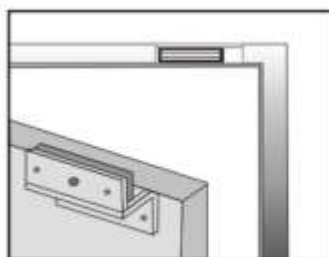

ZL-Shaped Bracket

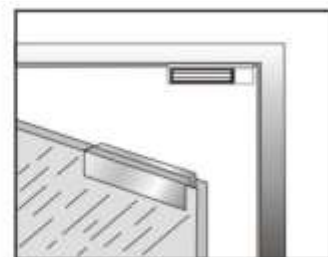

U-Shaped Bracket (glass)



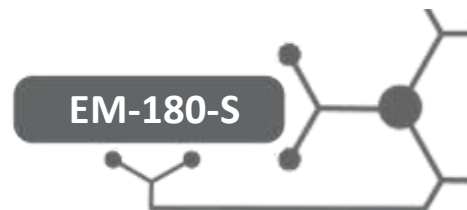

## Warranty

Every product marketed by Triplo W Lda., have a two-year warranty for manufacturing defects. Every equipment sold is checked at our facilities for defects; and if it is unrepairable, it shall be replaced with a new product, according to the corresponding warranty.

For additional information check our conditions of sale at:  
<https://www.triplow.pt/loja/termos-e-condicoes>

