

DATA SHEET

Single-Door Access Control Panel



TW-Board

- Power Supply: 12V DC
- Capacity: 1000 users
- Compatible with Wiegand 26 readers
- Single-door control panel
- Allowed operating temperature: -40 °C to 60 °C
- Weight: 100g
- Size: 65 x 54 x 19 mm
- TW-Board is a single-door controller and has the advantage that it can be installed inside a place or outside out of reach. The controller differs from other equipment, where are the readers the ones controlling the door.

Dimensions



Units: mm





Triplow W

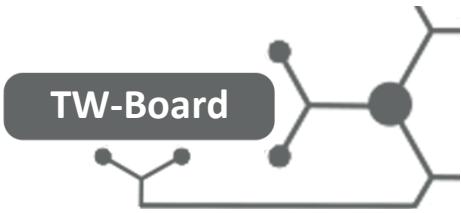

Compatibility with Different Readers



Wide compatibility with a variety of readers.



Data Transfer Mode between the TW-Board

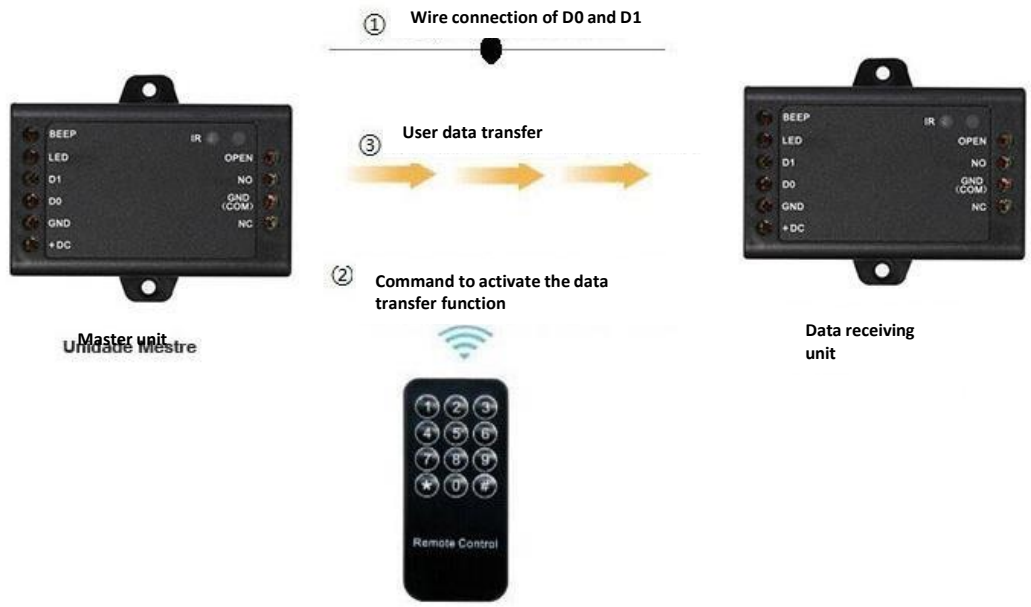

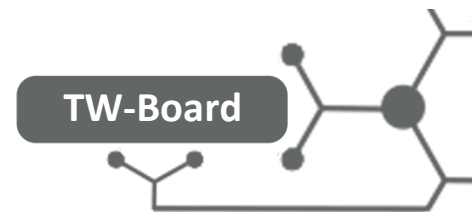

Setting and Operating Mode

- The access control programming is performed by means of an **IR command**.

Enter programming mode

Enter programming mode	* (Programming password) # NOTE: Factory-default programming password is 123456.
Exit programming mode	Press *

Modify programming password

Instruction	Programming code
1. Enter programming mode	* 123456 #
2. Modify programming password	0 (New password) # (Repeat new password) #
3. Exit programming mode	*

Add card with automatic ID assignment

Instruction	Programming code
1. Enter programming mode	* (Programming password) #
2. Add card (With automatic ID)	1 (Read card) #
3. Exit programming mode	*



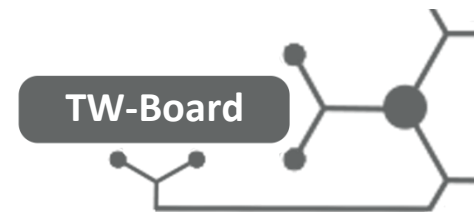

Add card by card number

Instruction	Programming code
1. Enter programming mode	* (Programming password) #
2. Add card by number	1 (Card number) #
3. Exit programming mode	*

Add card with specific ID

Instruction	Programming code
1. Enter programming mode	* (Programming password) #
2. Add card	1 (ID from 0 to 997) # (Use card) #
3. Exit programming mode	*

Add code with automatic ID

Instruction	Programming code
1. Enter programming mode	* (Programming password) #
2. Add user	1 (Enter code of 4 to 6 digits) #
3. Exit programming mode	*

Add code with specific ID

Instruction	Programming code
1. Enter programming mode	* (Programming password) #
2. Add user	1 (ID from 0 to 997) # (Enter code of 4 to 6 digits) #
3. Exit programming mode	*



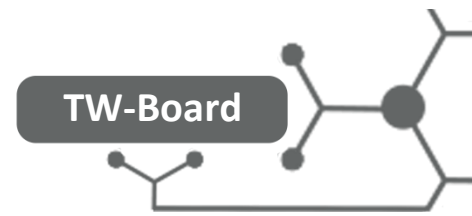

Add fingerprint with automatic ID

Instruction	Programming code
1. Enter programming mode	*(Programming password)
2. Add user	* (Enter fingerprint) (enter fingerprint again) #
3. Exit programming mode	*

Add fingerprint with specific ID

Instruction	Programming code
1. Enter programming mode	* (Programming password) #
2. Add user	1 (ID from 0 to 997) # (Enter fingerprint) (enter the same fingerprint again) #
3. Exit programming mode	*

Delete cards or codes

Instruction	Programming code
1. Enter programming mode	* (Programming password) #
2. Delete card code by ID	2 (ID to be deleted) #
3. Delete user by card or code	2 (Read card or enter code to be deleted) #
3. Exit programming mode	*

Delete all users

Instruction	Programming code
1. Enter programming mode	* (Programming password) #
2. Delete all users	2 (Programming password) #
3. Exit programming mode	*

Reset

1. Disconnect power supply.
2. Connect OPEN with GND (or if there is an exit button, press it).
3. Connect power supply (los cables unidos o presionando el botón) hasta que se emitan 2 bips y el led se quede en anaranjado.
4. Si hay tarjetas ADD y DELETE, añadir primero la tarjeta ADD e inmediatamente la tarjeta DELETE (por ese orden).
5. Led is steady in red.

ATTENTION: User data are not deleted.



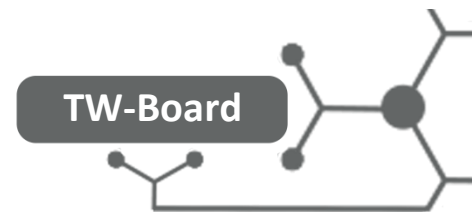

Timer

Instruction	Programming code
1. Enter programming mode	* (Programming password) #
	Timer: 3 (1 to 99 seconds) #
2. Timer or Toggle mode	Toggle mode (Card is used once and door opens, card is used once again and door closes): 30 #
3. Exit programming mode	*

Access mode

Instruction	Programming code
1. Enter programming mode	* (Programming password) #
	Card only: 40 # Card + Code: 41 # (NOTE: In case it is a card and code reader) Card or Code: 42 # (Factory default)
2. Access mode	
3. Exit programming mode	*

Sound settings

Instruction	Programming code
1. Enter programming mode	* (Programming password) #
	Deactivate Sound : 70 #
2. Activate/Deactivate sound	Activate Sound : 71#
3. Exit programming mode	*





Triplow W

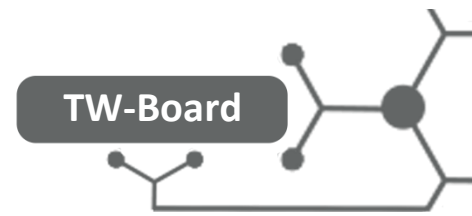

User data transfer mode between two TW-SX3

Connection Diagram

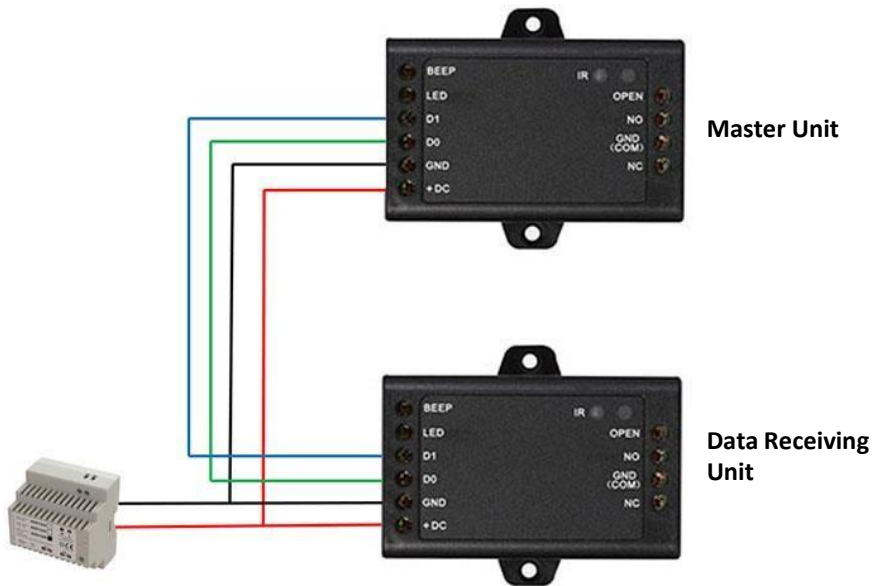

Instruction	Programming code
1. Enter programming mode	* (Programming password) #
2. Activate/deactivate alarm	On the TW-BOARD that contains the data to be copied: 96# NOTE: The green LED turns on and when all the information is transferred, there is a beep and the LED turns red.
3. Exit programming mode	*



Light and Sounds

Led	Sound	Meaning
Fixed red	-	Pause
Intermittent red	1 short beep	Enter programming mode
-	3 short beeps	Programming mode
Fixed red	1 short beep	Exit programming mode
Green	1 short beep	Successful operation or successful opening

