



FICHA TÉCNICA

Electroímã 180Kg com LED



YM-180N(LED)

- Modelo: YM-180N(LED)
- Força de tracção: 180 Kg
- Voltagem de trabalho: 12 V/400mA ou 24 V/200mA
- Temperatura de trabalho: -20 ~ +55°C (-4-131°F)
- Segurança de pessoas: Abre com falta de tensão
- Com LED indicador de estado
- Caixa em alumínio anodizado
- Magnéticos em aço zincado
- Placa em aço zincado
- Tamanho: 185x42.8x22.4 mm

Dimensões

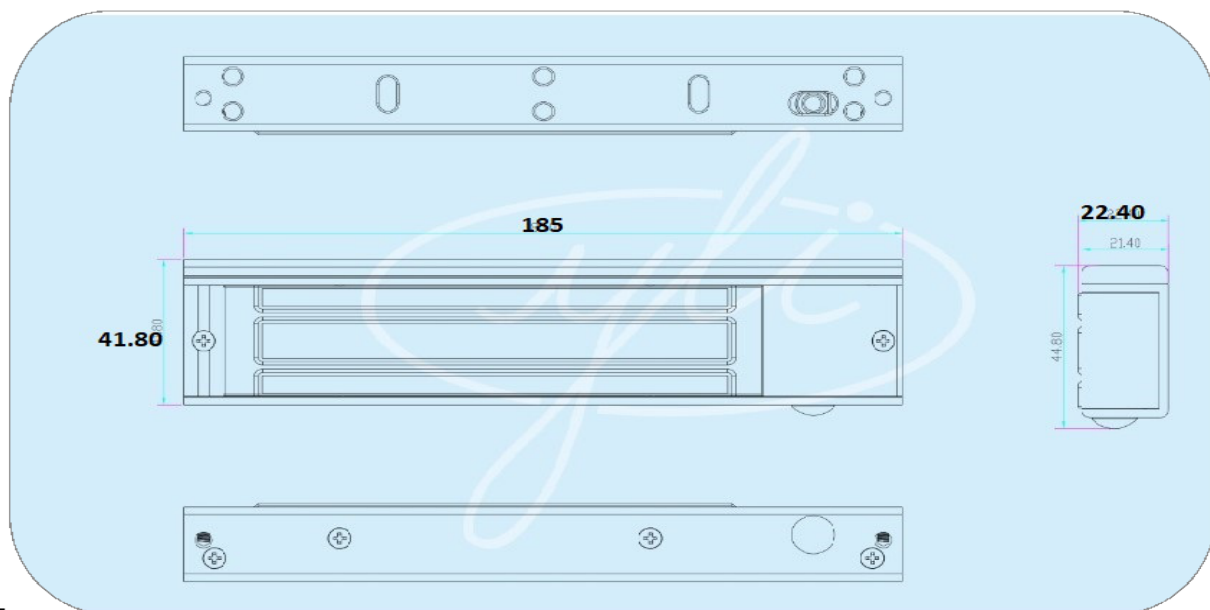



Triplow W

YM-180N(LED)



Instalação

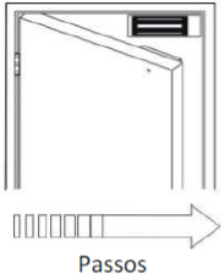

Passos

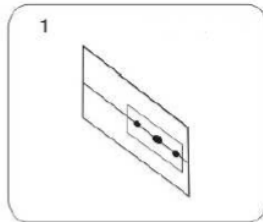

1 Escantilhão

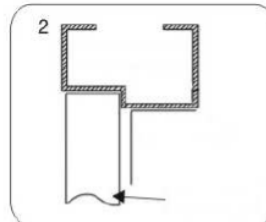

2 Feche a porta, encoste o escantilhão no aro

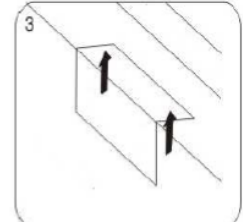

3 Marque os furos no Aro e na porta

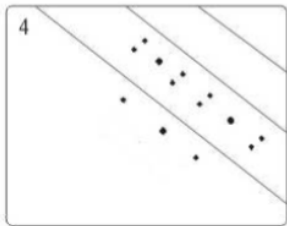

4 Fure com a broca adequada

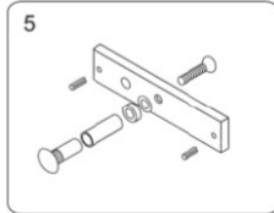

5 Instale a contraplaca na folha da porta

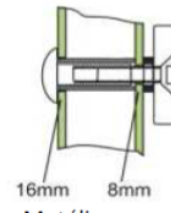

16mm 8mm
Metálica oca
Furo int. 8mm
Furo ext. 16 mm

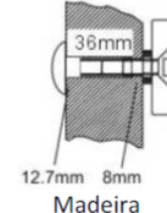

36mm
12.7mm 8mm
Madeira
Furo int. 8mm
Furo ext. 13 mm

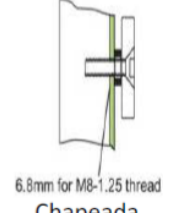

6.8mm for M8-1.25 thread
Chapeada
Furo int. 8mm

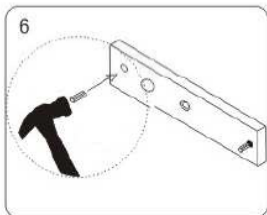

6 Coloque os pinos na contra-placa

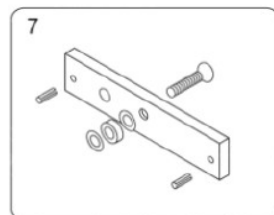

7 Coloque as anilhas na contra-placa de acordo com o desenho

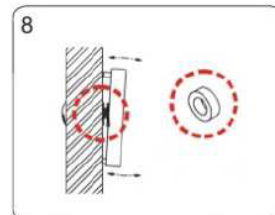

8 Coloque as anilhas entre a contra-placa e a porta

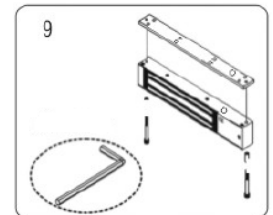

9 Use a chave sextavada para remover a placa de montagem

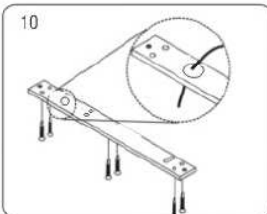

10 Passe o cabo pelo furo e aperte a placa no aro

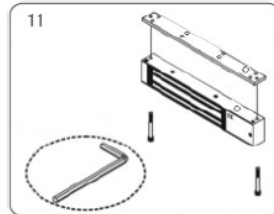

11 Aperte o corpo da fechadura à placa

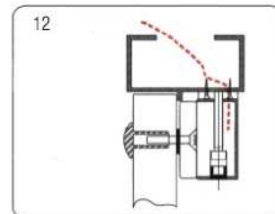

12 Feche e puxe a porta para testar a força de tracção

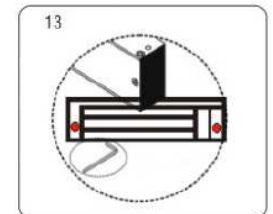

13 Reaperte os parafusos de fixação





Instalação de esquadros

Esquadro em L

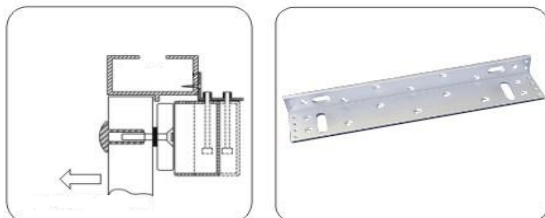

Quando o aro porta tem largura inferior a 42 mm ou a porta abre para fora é necessário instalar o esquadro L

Esquadro em ZL

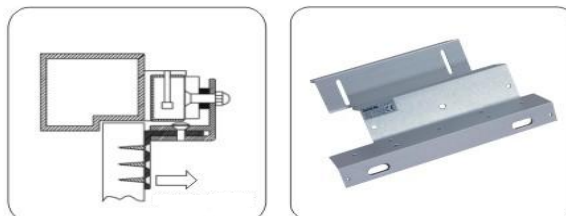

Quando a porta abre para o interior é necessário instalar o esquadro ZL

Esquadro em U

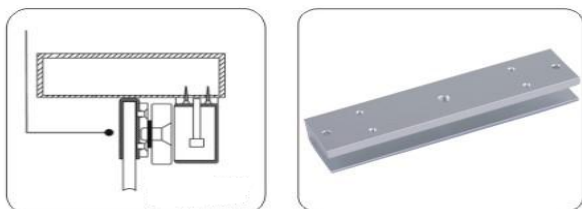

Para portas em vidro temperado de 10 a 15 mm de espessura é necessário usar a luva em U

Esquadro em GZ



Adequado para portas em vidro de 10 a 15 mm de espessura de caixa/perfil mais estreito

Instruções de instalação

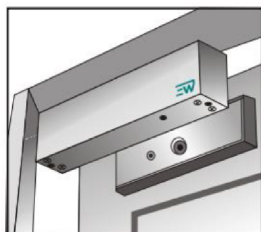

Fixação Directa

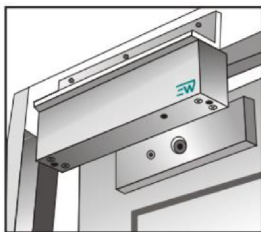

Esquadro L

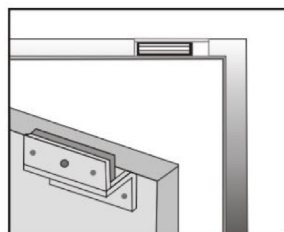

Esquadro ZL

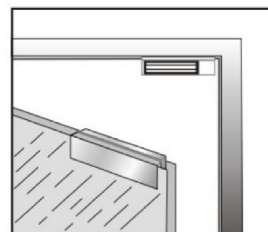

Esquadro U (vidro)

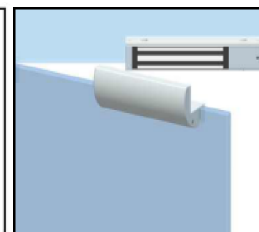

Esquadro GZ





Configuração da Alimentação e temporizador

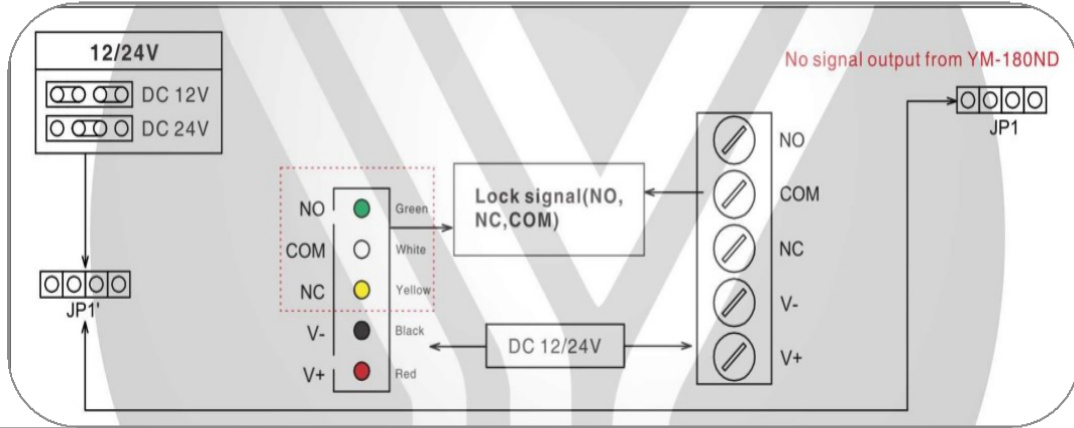

Esquema eléctrico

Sensor do estado da porta:

Verde: A porta está correctamente fechada

Vermelho: A porta está mal fechada

Sem luz: A porta está em uso ou sem corrente (porta aberta)

