

## DATA SHEET

### Electric Bolt Lock with Mechanical Cylinder



YB-500C

- Model: YB-500C
- Magnetic plate : 90 x 25 x 3 mm
- Bolt: 16 mm (throw), 13 mm (diameter)
- Holding force: 1000Kg
- Cylinder: External side: key – Internal side: Handle (75mm)
- Voltage: 12V DC
- Current: Operation: 900mA - Standby: 180mA
- Output signal: NO/COM
- Led: Green: Open door - Red: Closed door
- Material: Stainless Steel, dull polished (304)
- Induction distance: 8 mm
- Operating mode: Fail Secure (door closes in case of power failure)
- Weight: 1Kg

### Dimension

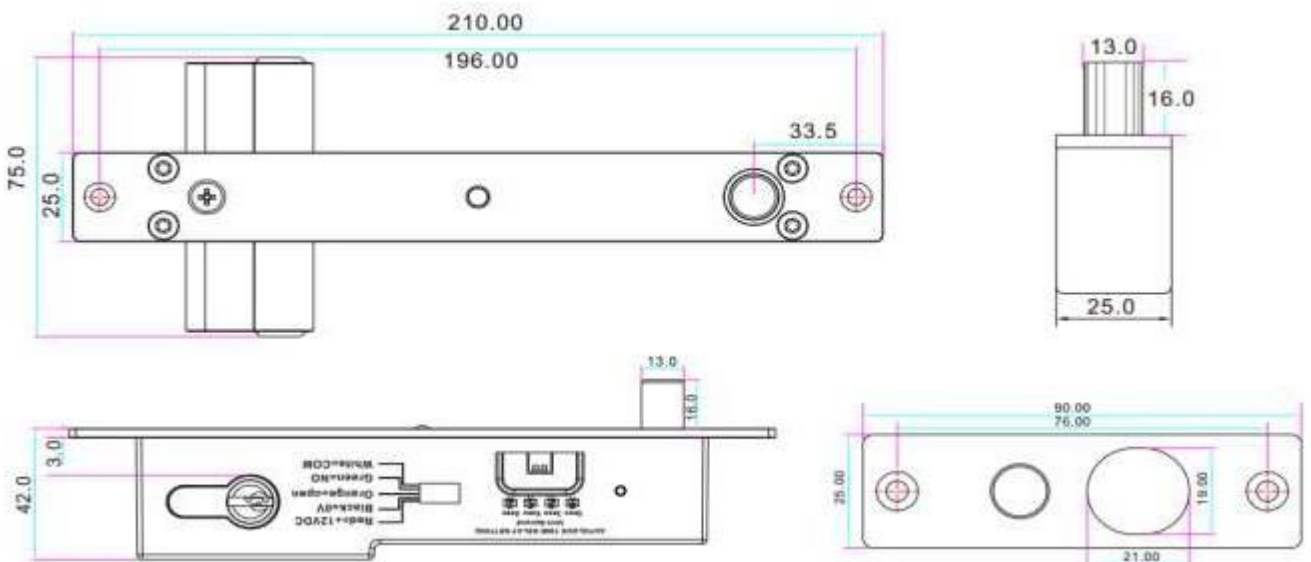

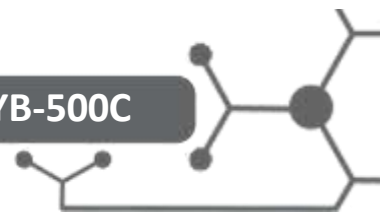

## Installation Steps

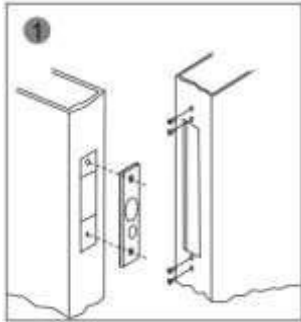

1 Mark the hole size on the door and cut it for the latch body and magnetic plate.

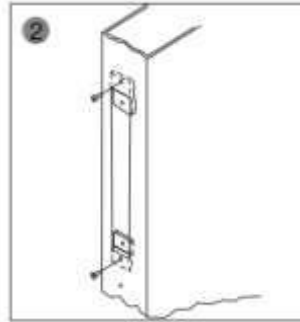

2 Install fixing plates.

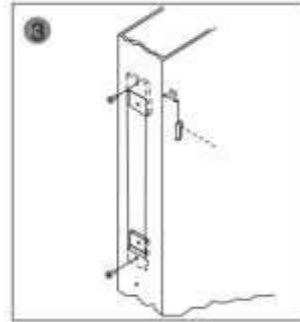

3 Cut the hole for the cylinder.

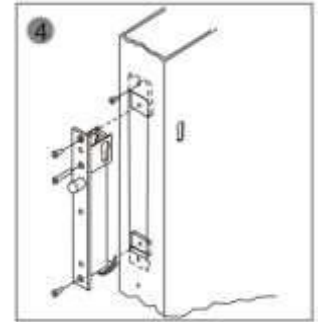

4 Connect the voltage to the latch (12 V DC).

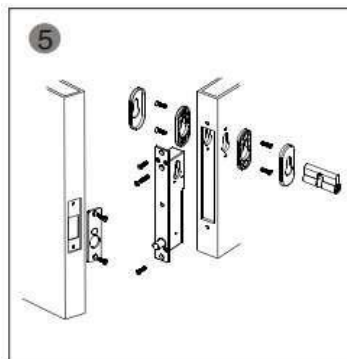

5 Set the latch body in place and install its cylinder and plates.

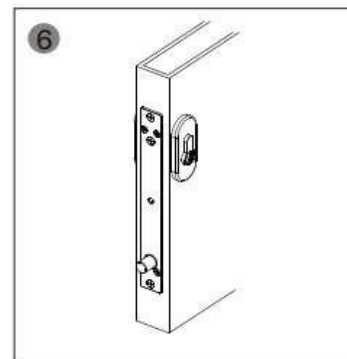

6 Set the latch body in place and install its cylinder and plates.





# Triplow W

YB-500C

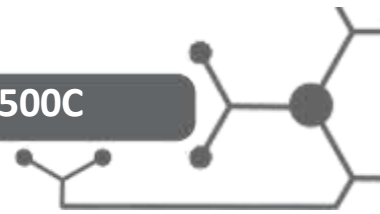

## Timer Setting

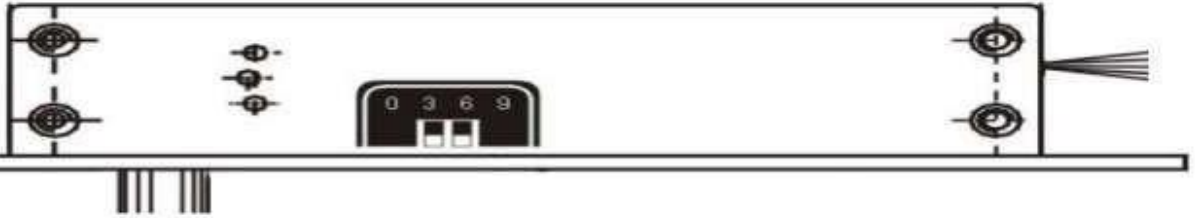

Timer setting for 0 seconds.

NOT RECOMMENDED!



Timer setting for 3 seconds.



Timer setting for 6 seconds.



Timer setting for 9 seconds.

**ATTENTION:** In order for the equipment (YB-500C) to work properly, use the timer only at 3, 6 or 9 seconds.





## Maintenance and Installation Care

1. The maximum force that the solenoid puts on the lock bolt is not greater than 50 grams. The cleaning and lubrication of the bolt and the rest of components must be ensured so its proper operation is guaranteed without making an effort greater than the solenoid force.

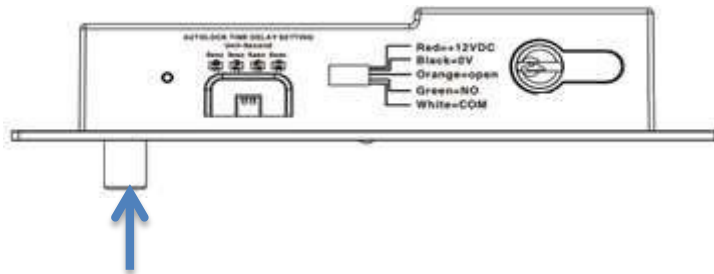

Retracting force of bolt up to 50g

2. Make sure the hole for installing the lock has the correct measurements in order to guarantee the perfect mounting of the lock.
3. After installing the lock, the cleaning must be carried out by using compressed air inside the lock to guarantee that there is no wood, aluminium, sand or concrete residue that might block the perfect sliding of every mobile part.
4. After cleaning, the mechanical elements must be lubricated with spray.
5. When the lock is installed in hostile environments such as sea surroundings or chemical pollution sources, among others, the following additional tips should be carried out:
  - a) Periodically clean and lubricate mobile elements, as previously stated.
  - b) Fill up the connecting cable hole and every other fixing hole with a good quality filler.
  - c) Clean contact-exposed surfaces with a fine oil moistened cloth. This operation needs to be carried out once a month.
6. Make sure the lock is perfectly aligned.



Incorrect alignment

Correct alignment

