

## TECHNICAL SHEET

Electric lock with signal and adjustment, without power supply, door closed



YS-134

- Model: YS-134
- Fail-Secure (No power when door is closed)
- With open or closed door sign
- With adjustment
- Measurements (latch without escutcheon): 74 (L) x 16 (W) x 27 (H) mm
- Voltage: 12V DC 280mA
- Output signal: NO/NC/COM
- Installation: Wooden or metal doors
- Available in 3 mirror types

## Dimensions

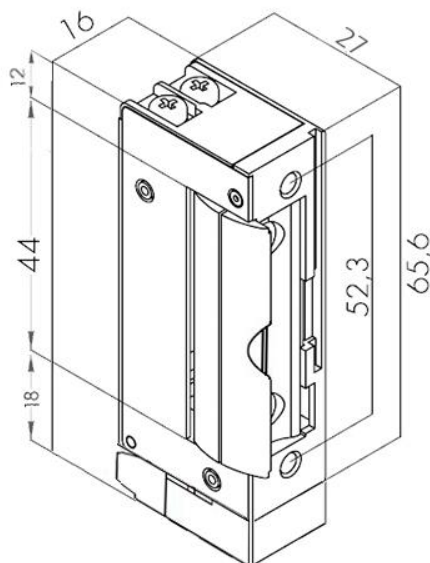
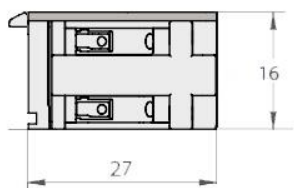

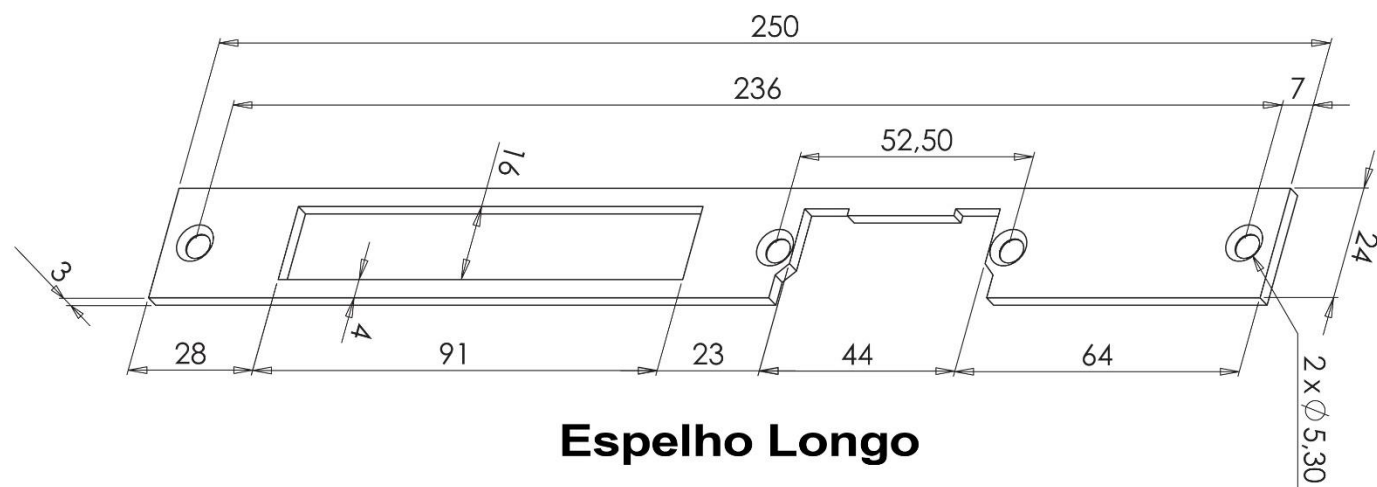
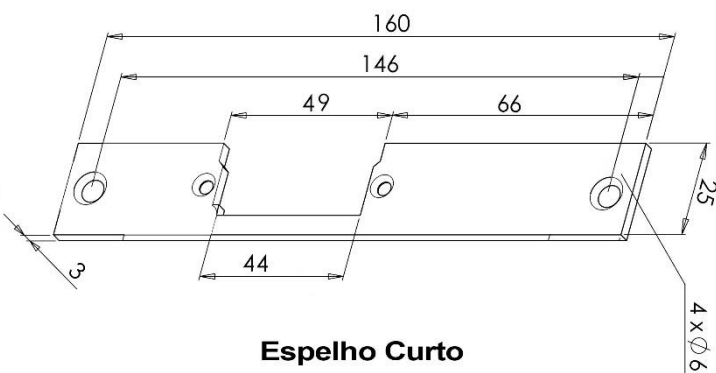
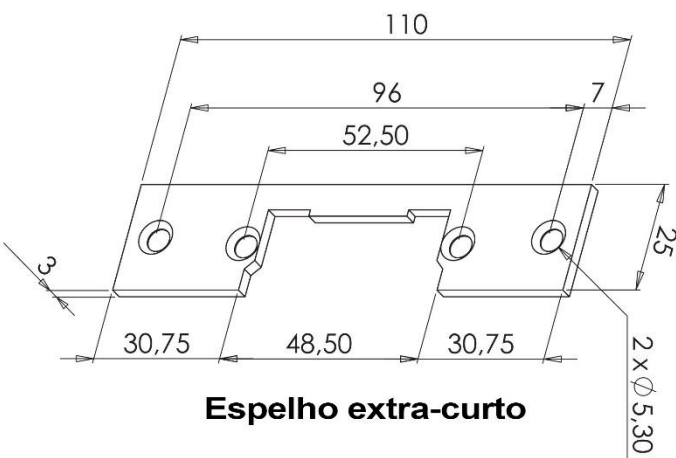

## Drilling Scheme

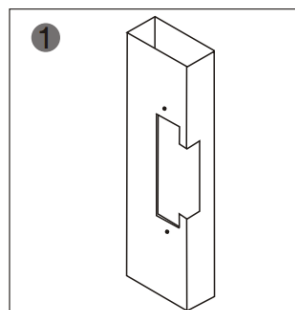

1 Cut hole according to the size of the latch.

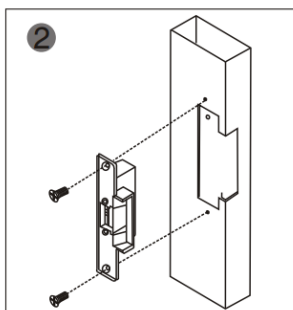

2 Assemble the lock and turn on the power to test.

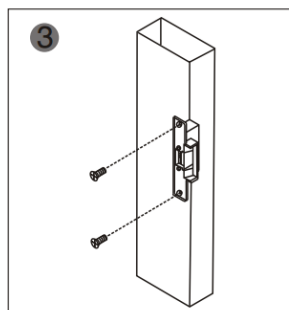

3 Fix the electric latch.

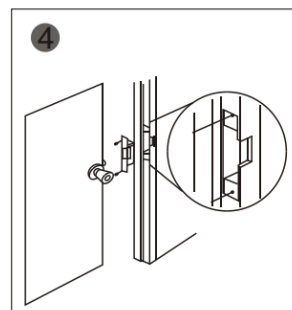

4 Finished.





## Electrical diagram

