



TRIPLO W
Criamos Segurança!

Installation Guide
User Manual

TW2 0 Q

**Cabinet lock with
remote management, Bluetooth**

iOS



ATTENTION:

Leia o manual com atenção antes da instalação e guarde-o para uso futuro.

Guarde as chaves mecânicas num local seguro para, em caso de avaria ou emergência, poder abrir a porta mecanicamente.

Tenha atenção ao nível de bateria para poder efectuar a substituição das pilhas atempadamente.



Installation Video



www.triplow.pt

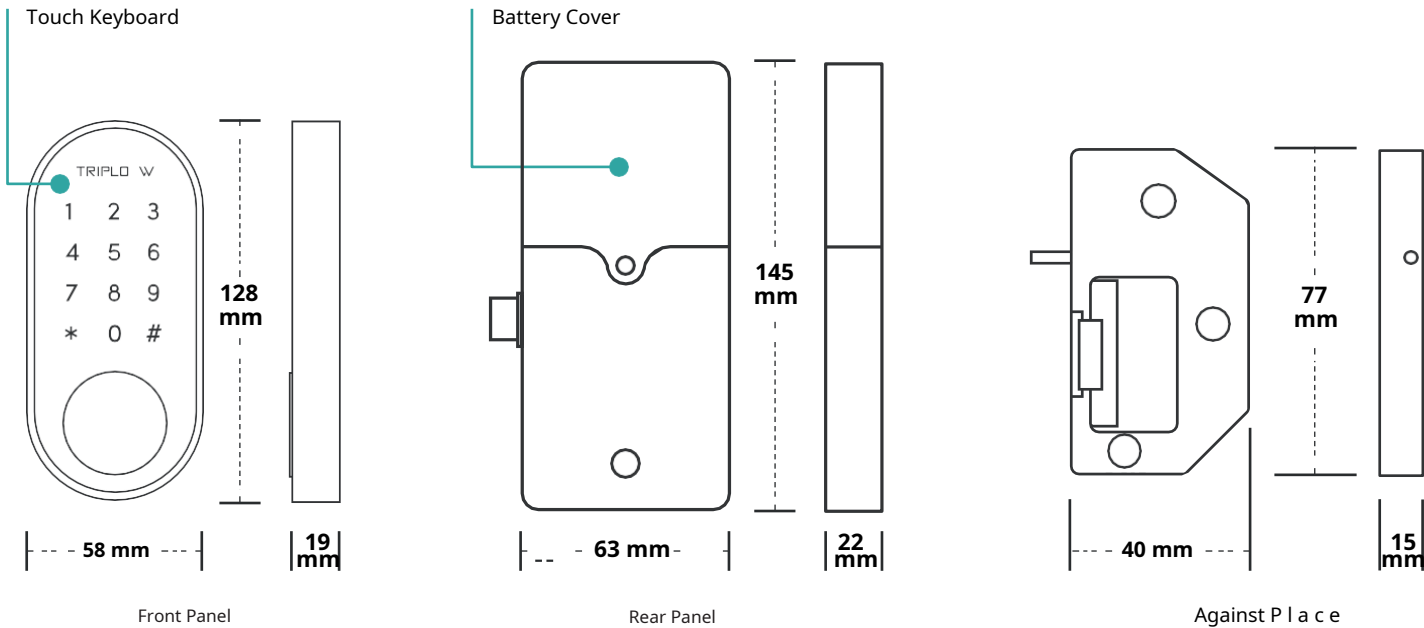

Technical Specifications



League of
Zinc



| | |
|--------------------------|--|
| MODEL | TW20Q |
| MATERIAL | Zinc Alloy |
| COLOR | Silver / Black |
| PANELS (mm) | Front Panel 125 x 58 x 19 mm Rear Panel 145 x 65 x 22 mm Counter Plate 77 x 40 x 15 mm |
| WEIGHT (KG) | 2.5 kg |
| TYPES OF OPENING | Bluetooth, Proximity Card, Code |
| DOOR TYPES | Aluminum / Wood Doors |
| BATTERIES/VOLTAGE | 4 x AAA 6V Batteries(not included) |
| DATA CAPACITY | 150 Codes and 200 Cards |
| WORKING TEMPERATURE (°C) | - 25° +60° C |
| LOW VOLTAGE ALARM (V) | Less than 4.5V |
| SOS CHARGING | Micro USB input |

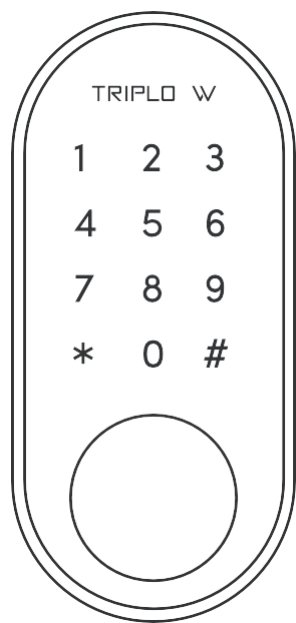

x1

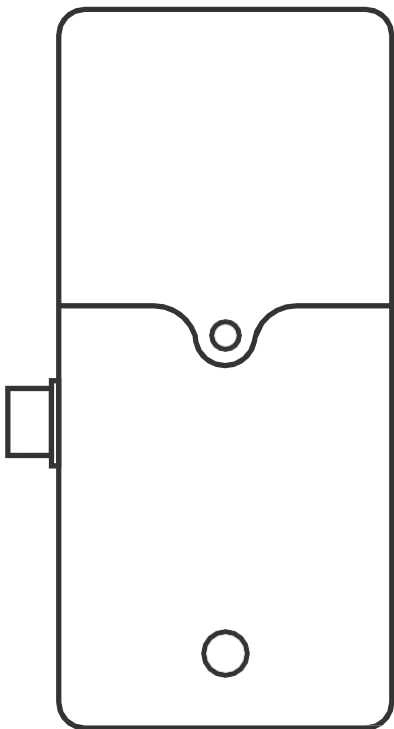

x1

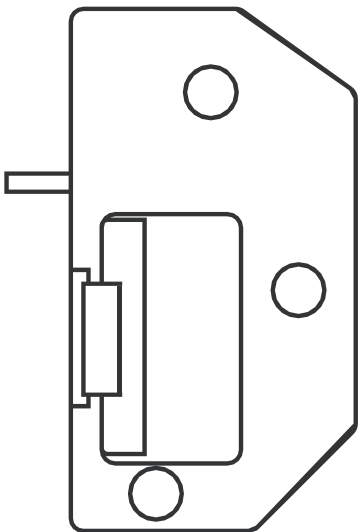

x1

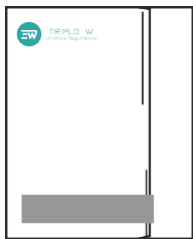

x1

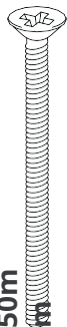

50m
x1

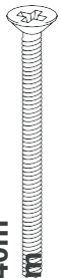

40m
x1

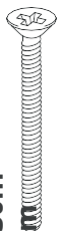

30m
x1

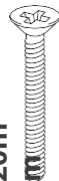

20m
x1

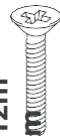

12m
x1



25m
x4

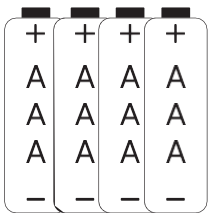
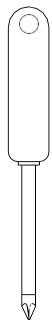

4 x AAA 6V

(Accessories not included)

NOT INCLUDED
(optional)

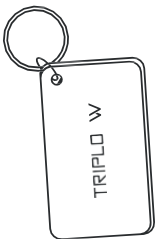

TAG

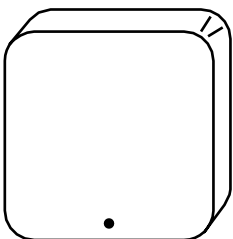

TW- GAT E

Check the door's opening/closing direction and the spacing between the door and the fixed part where the counterplate will be located. Test the lock's operation before closing.

1

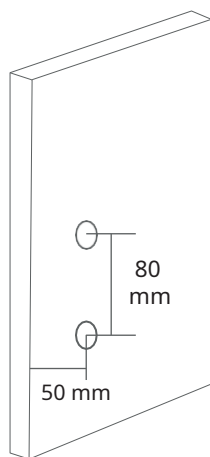

2

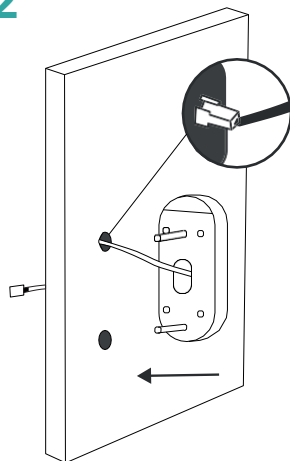

3

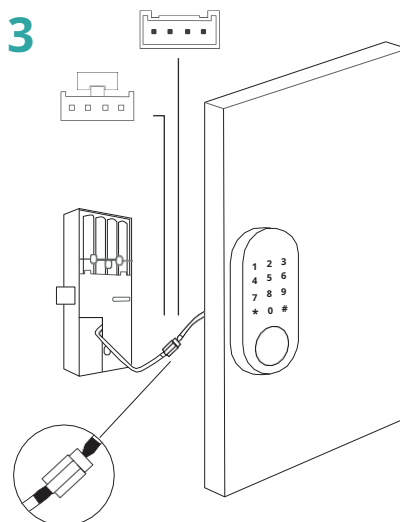

4

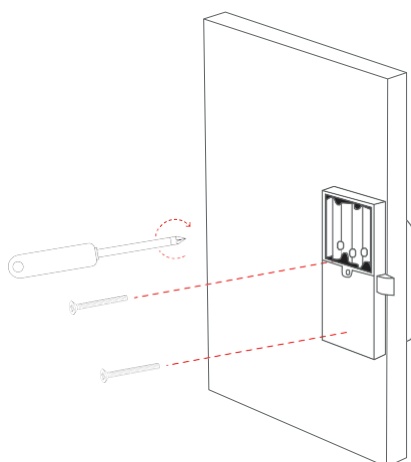

5

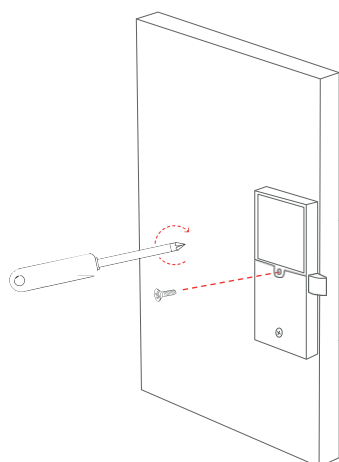

6

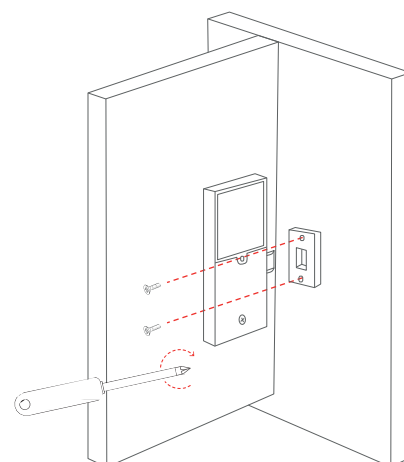

FEC HAS HARD RESET

BEFORE to close the battery compartment and with the lock on, the following must be done **RESET** manual of the same.

To do this, simply **press** the button **RESET** continuously during **5 seconds**, until the lock makes a sound. Then, type **"000000#"** on the exterior panel keypad. The reset process is complete and the lock is ready to be paired.

If the lock disconnects (e.g. incorrectly placed batteries come out of place), the process will have to be repeated).



Button
Reset

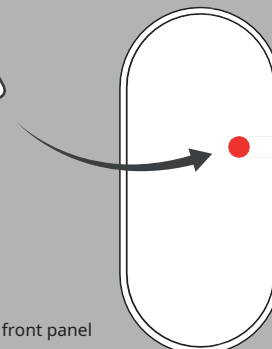

Inside
from the front panel

Lock installation is complete!

To pair and configure your lock, please use the QR code or the hyperlink to access the TTLock manual.



<https://triplow.pt/TTLOCK>

