

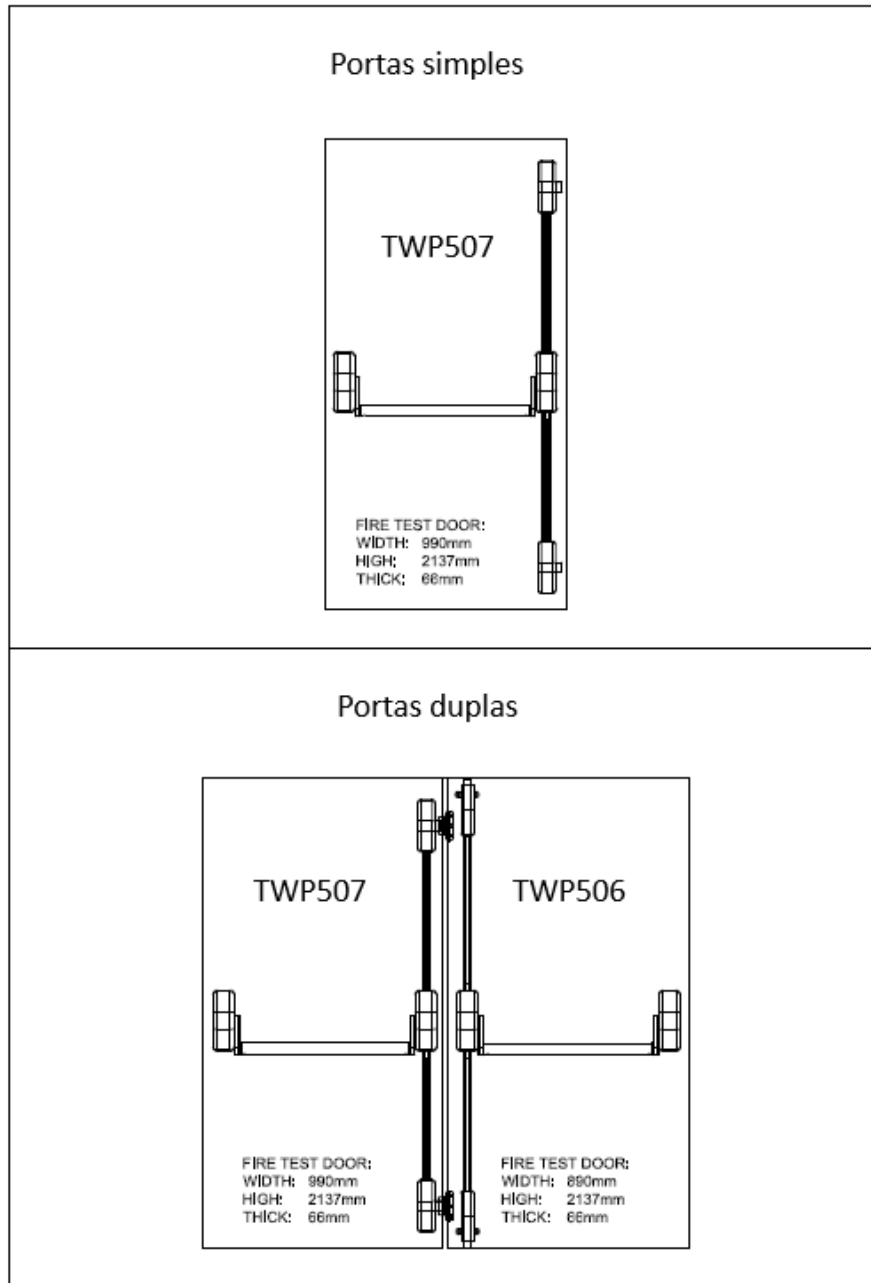

TWP507

Anti-panic bar with 2 locking points
lateral verticals



ATTENTION:

Leia o manual com atenção antes da instalação e guarde-o para uso futuro.

Guarde as chaves mecânicas num local seguro para, em caso de avaria ou emergência, poder abrir a porta mecanicamente.

Tenha atenção ao nível de bateria para poder efectuar a substituição das pilhas atempadamente.

A) VERTICAL \mathbb{C} :

Aplicação em porta simples

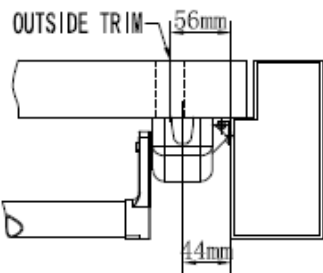

Aplicação em portas de duas folhas

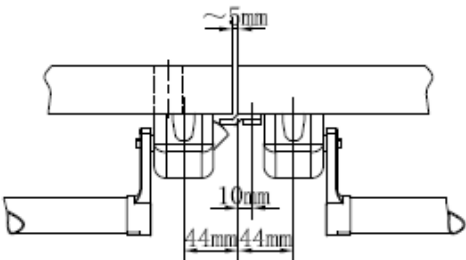

B) HORIZONTAL \mathbb{C} :

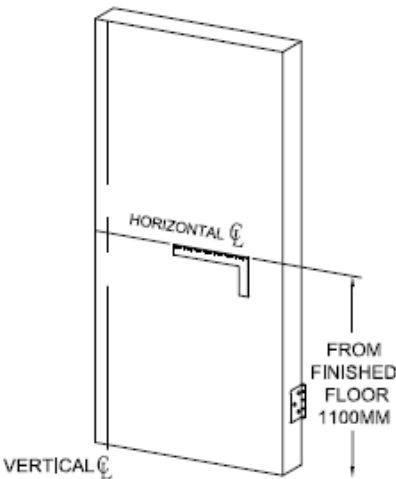

Package Contents

<p>Puxadores</p>	<p>Trincos verticais X2</p>
<p>Tubo da barra</p>	<p>Tubos verticais X2 e capas X2</p>
<p>Espelhos dos trincos 2</p> <p>SHEET (2 PCS)</p> <p>STRIKE (2 PCS)</p>	<p>Parafusos</p> <p>BRACKET (2 PCS)</p>

1. Use the template provided to define the holes in the door;
2. Drill the hole
3. If you are going to install the exterior handle, prepare the door for its application following the manual.
4. Determine the length of the bar:
 - A) the bar adapts to doors with a width between 400mm and 1000mm
 - B) measure the measurement indicated as "Y" in the image below
 - C) the length of the bar to be cut is identified with "X".

$$X=Y-150$$

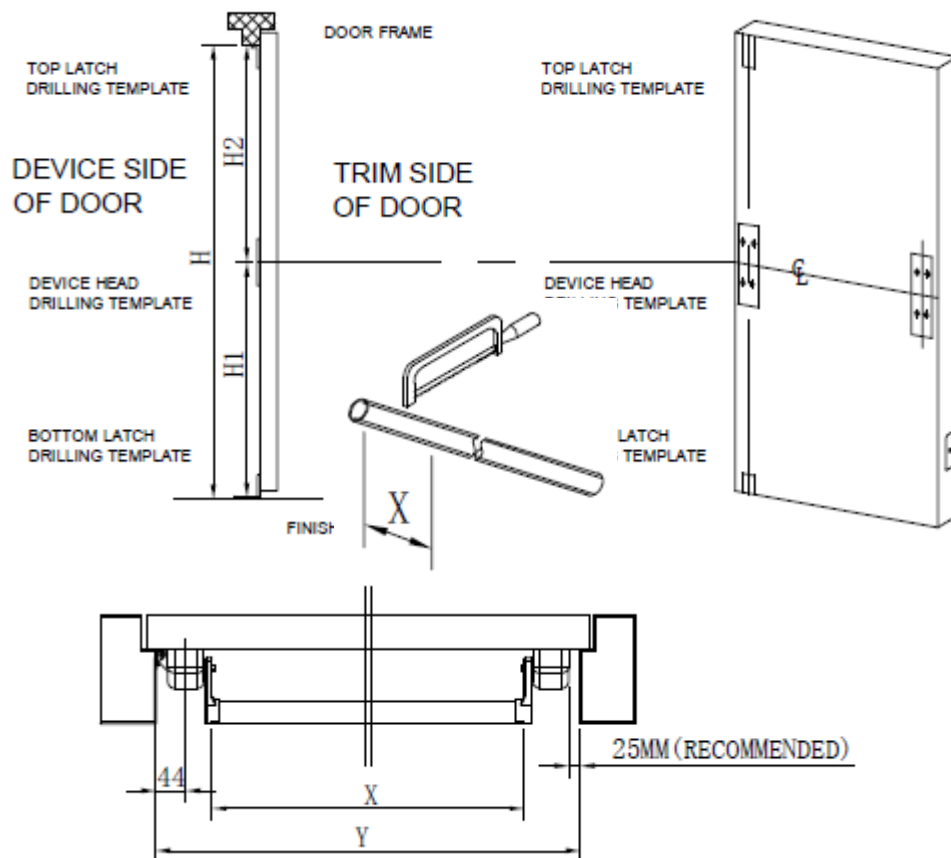

5. If the door length is less than 1000mm, cut the bar:

- A) Mark the bar from the end to the measurement
- B) Cut the sides and front of the bar and file

the shavings

NOTE: The manufacturer recommends cutting with a hand saw. Cutting with a power saw may damage the material.

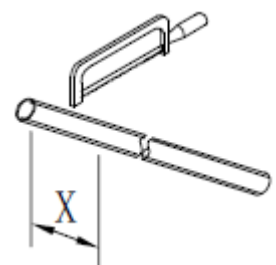

6. Door hand:

- A) The bar comes assembled for right-hand doors
- B) For left-hand doors, remove screws S1 and S2 securing the handles and remove the handles.
- C) Rotate the spindle 90°
- D) Change the position of the handles
- E) Install the bar on the handles, but do not screw the bar in.
- F) Cut the screws according to the instructions below and then screw them in.

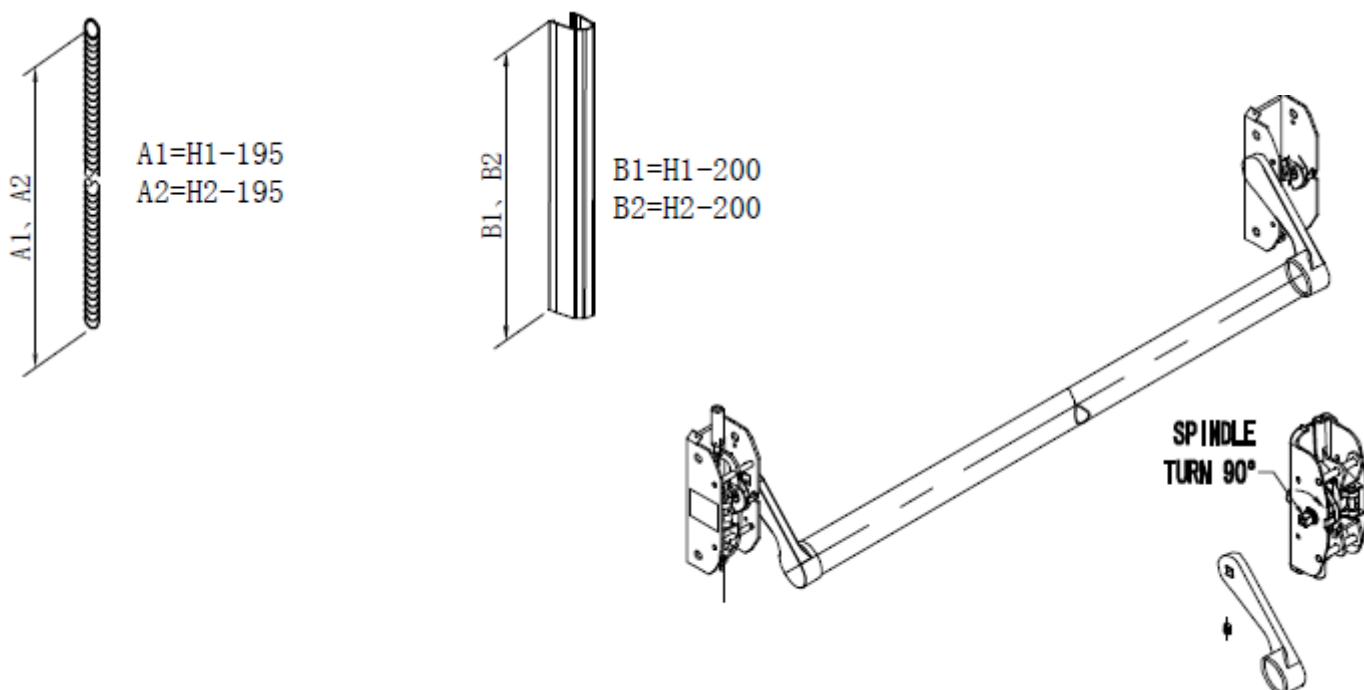

7. Cut the vertical bars and respective covers according to their adaptability to the door.

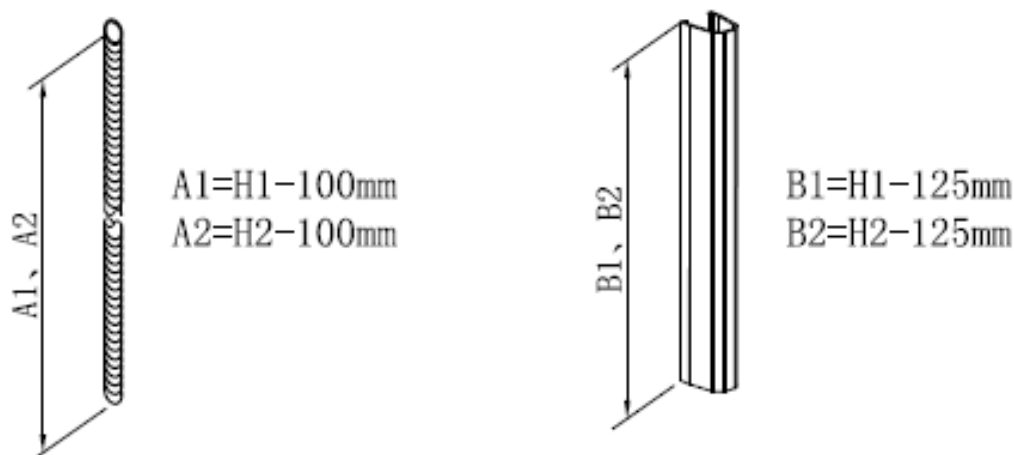

Installation

1. You must install the exterior handle first (if applicable)
2. Fix the bar first on the vertical locks side, and test the operation

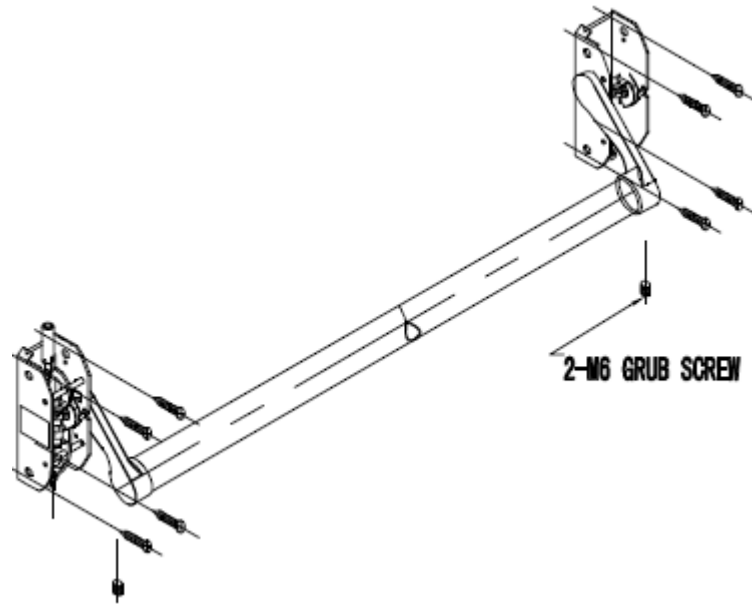

3. Install the vertical locks

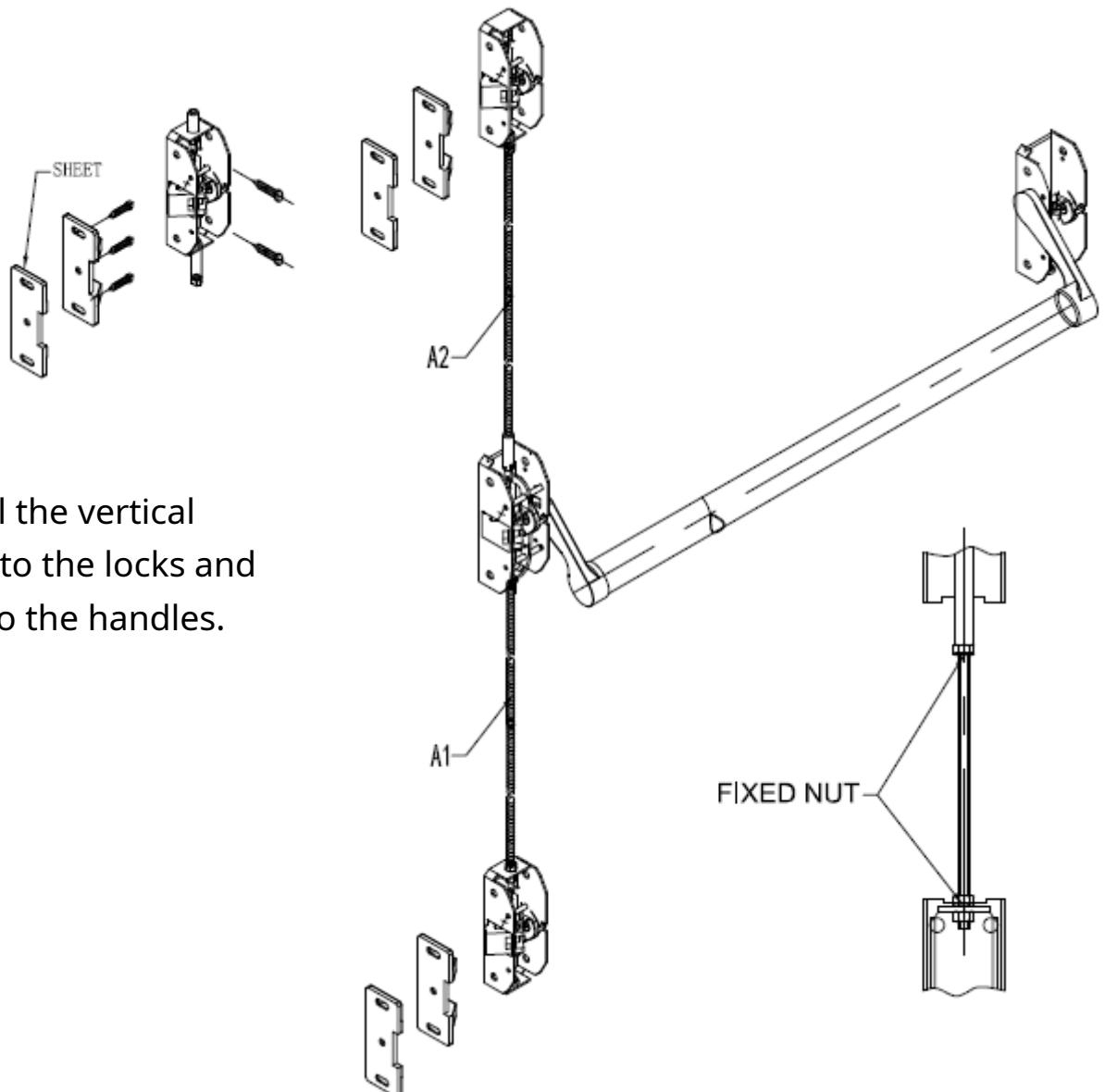

5. Install the vertical tubes into the locks and then into the handles.

6. Install the covers in the correct sequence and test each step:

A) Install the vertical bars (may need to cut to fit)

B) Install the vertical bar covers

C) Install the vertical lock covers

D) Install the handle covers

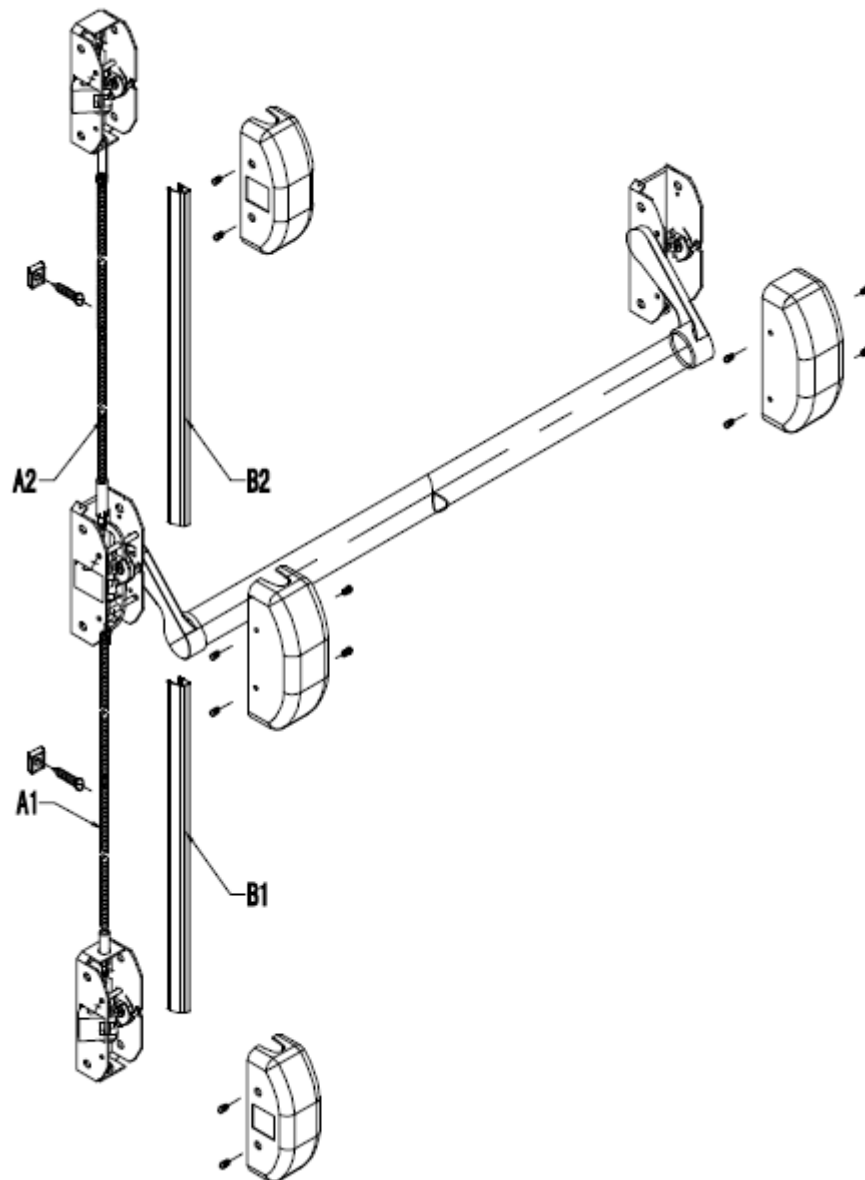

TEMPLATE

