



TECHNICAL SHEET

NC Fail-Secure Electric Strike Lock 12/24V, AC/DC with Memory



SE2MIO

Type of Opening	NC Fail-Secure - no power, door closed
Appropriate	Metal doors, Wooden doors
Latch	<ul style="list-style-type: none">• With adjustment - 4mm• Permanent lever open• Memory (open after impulse until door opening)
Dimensions	67 (L) x 20.5 (W) x 28.5 (H) mm
Food	12V AC/DC
Current	12V - 220/290mA 24V - 460/580mA

Dimensions

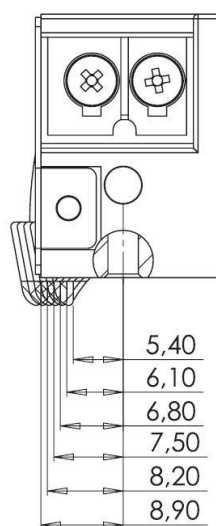
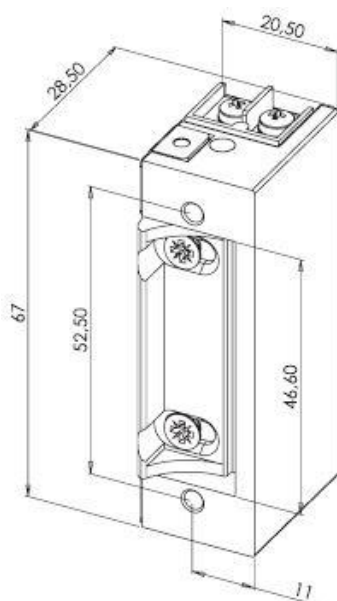

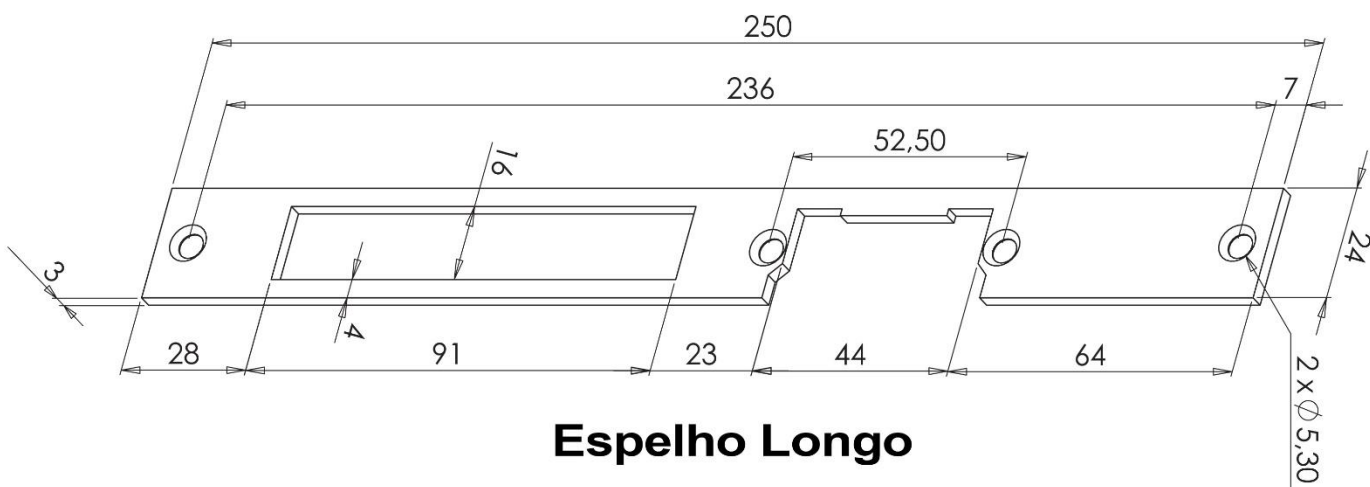
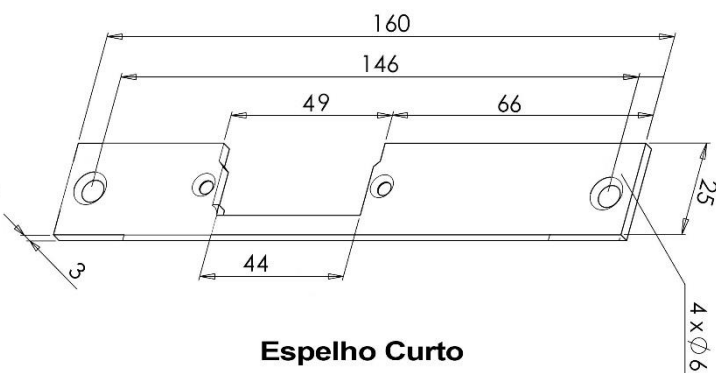
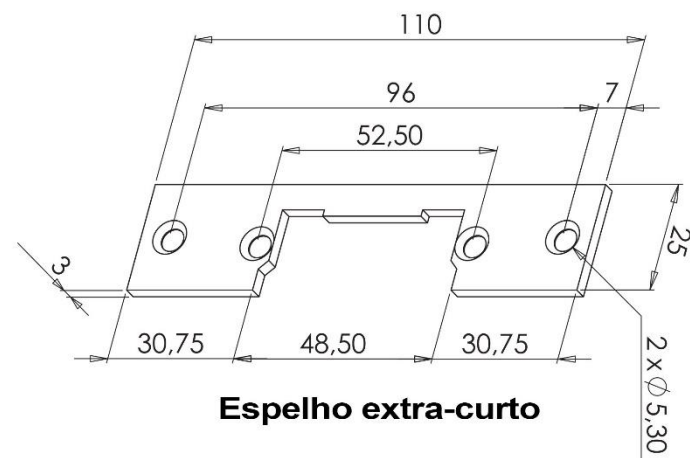

Drilling Scheme

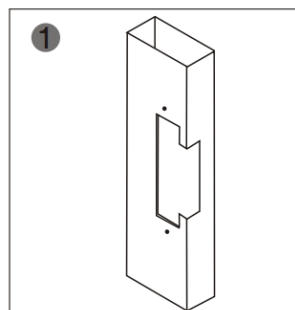

1 Cut hole according to the size of the latch.

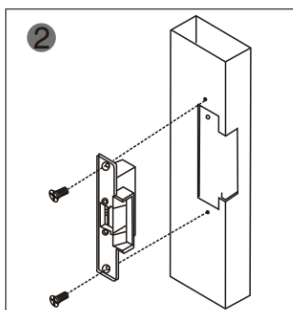

2 Assemble the lock and turn on the power to test.

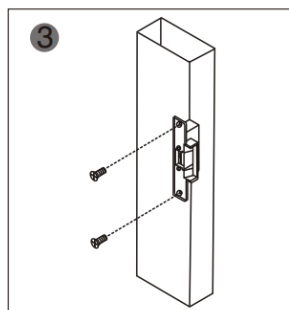

3 Fix the electric latch.

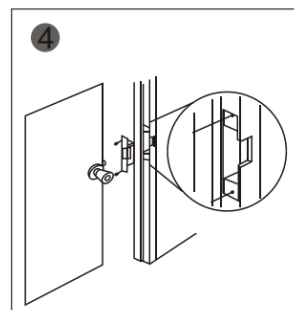

4 Finished.



Electrical diagram

