



PISTON LOCK WITH SIGNAL AND CYLINDER

Dimensions (mm)	270 x 30 x 48 mm Piston – 100 x 25 x 3 mm
Weight (kg)	1.6 kg
Output Signal	NO/NC/COM
Voltage (V)	12V DC
Current (mA)	Work 1200mA Standby 200mA
LED	Access light indicates closed, light off indicates open
Working method	Fail Safe
Detection distance	Less than 8 mm
Material	304 stainless steel

Technical drawing of a rectangular metal plate, showing three views: top, front, and side. Dimensions are in millimeters (mm).

Top View:

- Overall width: 260.00
- Overall height: 30.00
- Internal width (excluding side flanges): 240.00
- Features: Two circular holes on each long side, a central circular hole, and a central rectangular slot.

Front View:

- Overall width: 220.00
- Overall height: 38.50
- Side flange width: 20.00
- Central hole diameter: $\varnothing 16.00$
- Central slot width: 45.00
- Slot depth: 16.00
- Slot height: 3.00
- Slot offset from bottom: 34.90

Side View:

- Overall width: 28.50
- Central hole diameter: $\varnothing 16.00$
- Central slot width: 45.00

INSTALLATION

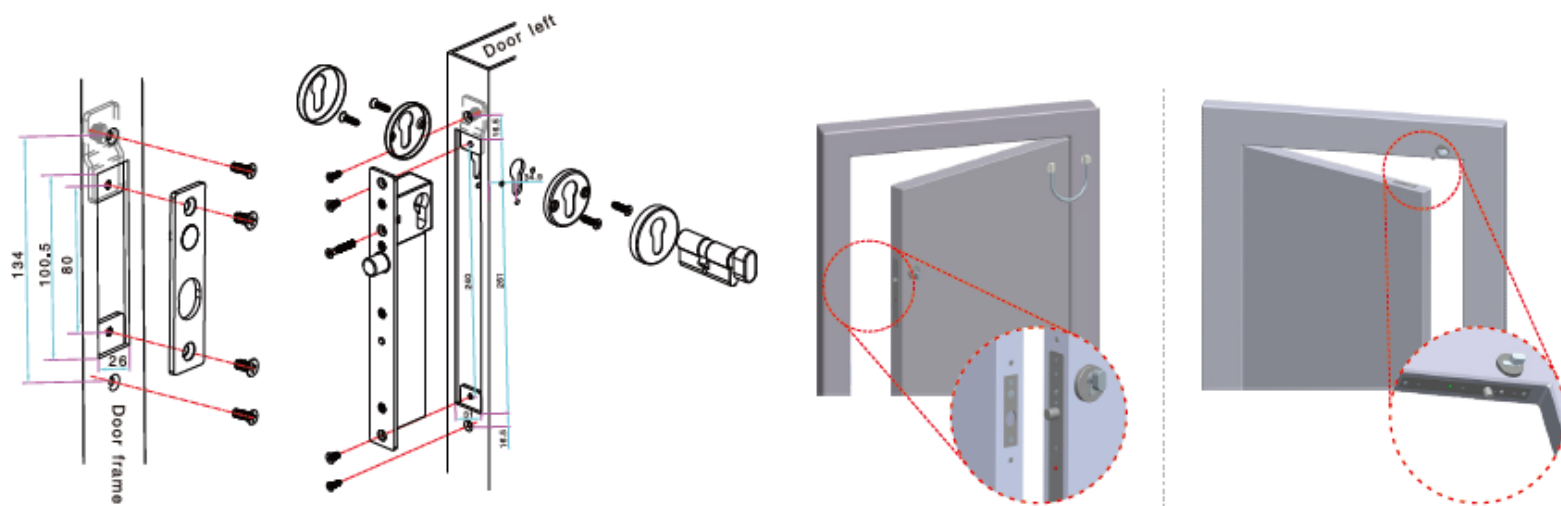

WIRING DIAGRAM AND SCHEME



Timer



