



Technical Characteristics

- Model: YR-168IC-EX
- Technology: MIFARE proximity card
- Dimension: 86 x 86 x 13 (mm)
- Voltage: 9-18 VDC
- Consumption: 25mA
- Induction distance: 3cm
- LED status: Red: closed Green: open
- IP rating: IP67
- Certificate No.: ECM 23 ATEX-B Dn89
- ATEX: II 1G Ex ib IIC T6 Gb
 - II 2D Ex ib IIIC T85°C/T100°C Db
- Working temperature: -40°C ~+60°C

It must be installed with an insulator between the access control and the electromagnet. Complies with European ATEX explosion-proof standards

It can be installed indoors and outdoors, and can be used widely.

in oil and petrochemical environments, ships, drilling platforms,
gas stations, aerospace, medicine, food processing and others
explosive hazardous environments.

TW-BOARD included

Links

No.	Colour	Wire Contact	Funtion
1	Red	+9~18V	+
2	Black	GND	-
3	Green	D0	Wiegand Signal Output
4	White	D1	Wiegand Signal Output
5	Brown	LED	Green Light Control Input



Triplow

TECHNICAL SHEET MIFARE card reader

YR-168IC-EX



Installation instructions

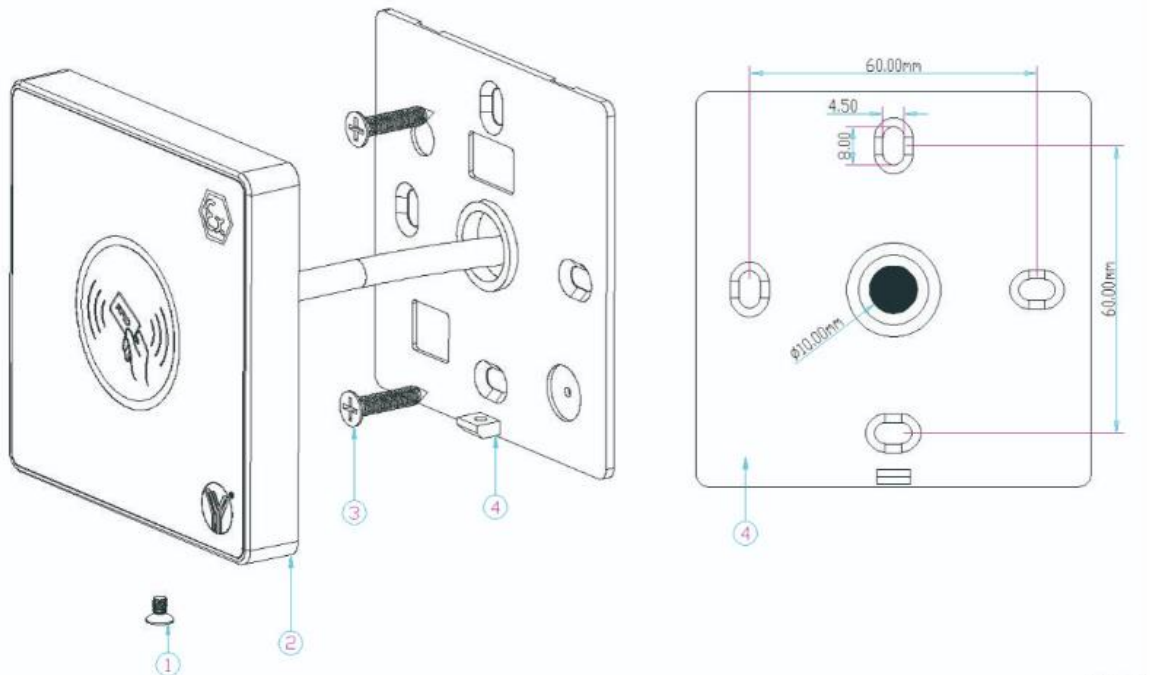

Electrical Diagram

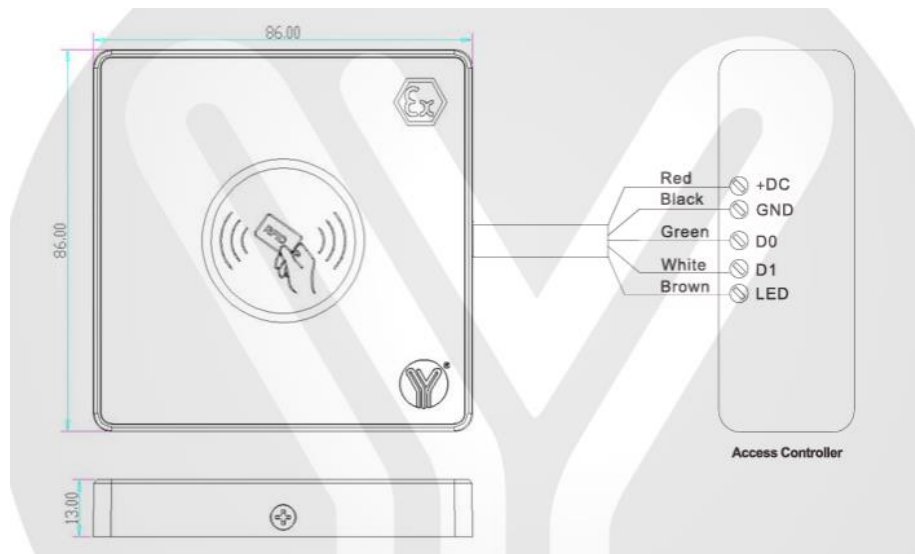

Wiring diagram

Controlo de acessos

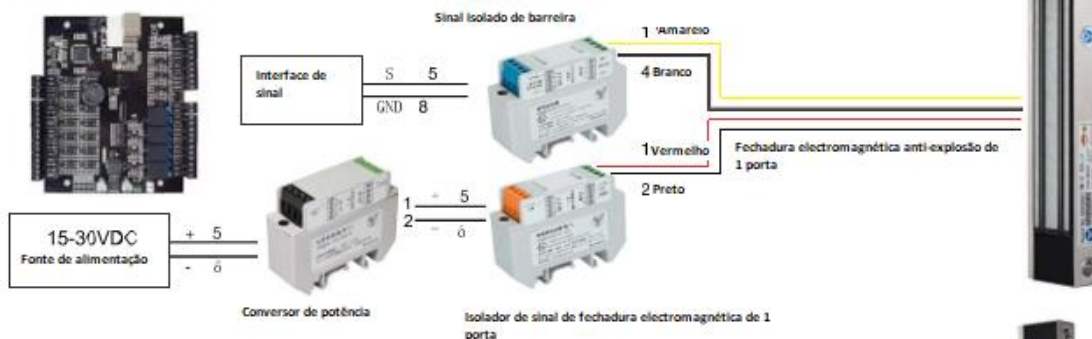

Controlo de acessos

