



# Triplo W

YM-280DW-EX



## TECHNICAL SHEET

### Electromagnetic lock for double-leaf ATEX doors

#### Technical Characteristics

- Model: YM-280DW-EX
- Lock dimensions: 516 x 48 x 25 (mm)
- Backplate dimensions: 180 x 38.8 13 (mm)
- Voltage: 12 VDC
- Consumption 550mA
- Traction force: 2X280Kg
- Electric cable length: 3m
- Waterproof: IP 66
- Applicable to doors made of: wood, glass, metal, fireproof and doors in sterile environments
- Certificate No. ECM 23 ATEX-B DN 89
- ATEX: II 1G Ex ib IIC T6 Gb  
II 2D Ex ib IIIC T 85°C/T100°C Db



#### Dimensions

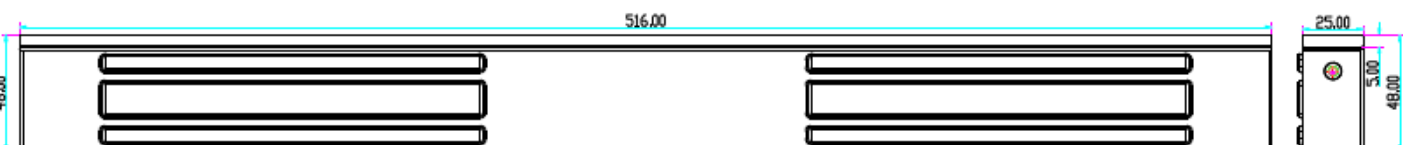
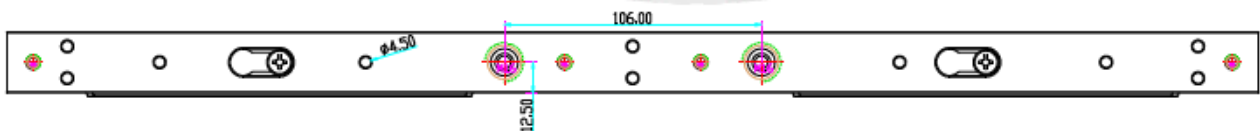
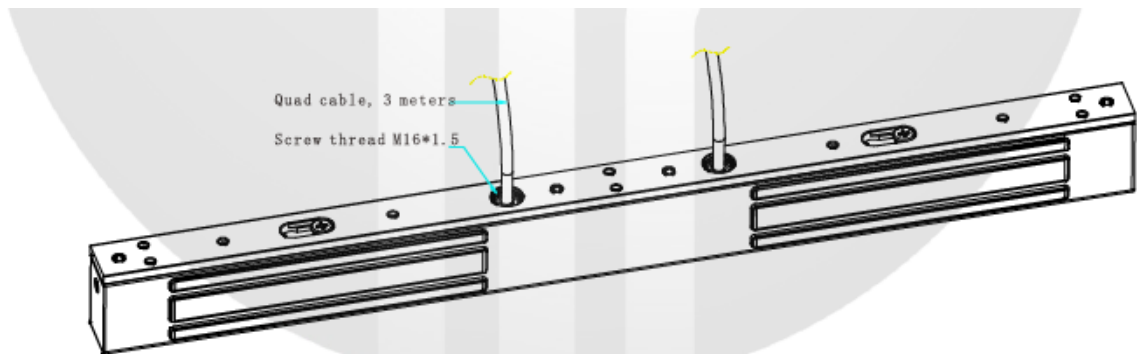

## Installation

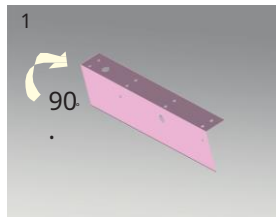
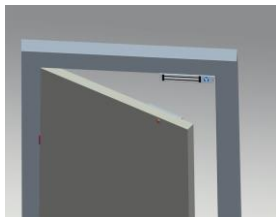

1 Fold the sheet with the markings;

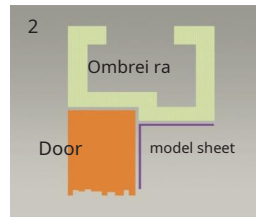

2 Close the door and place the template sheet with the markings in the desired position;

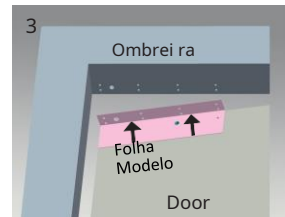

3 Mark the location of the screws on the fitting plate on the door and shoulder;

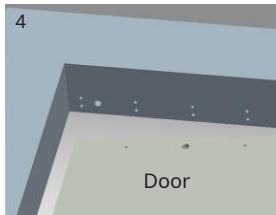

4 Drill the marks;

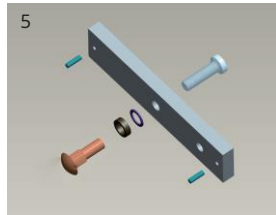

5 Fit the pieces onto the board;

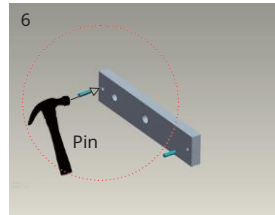

6 Using a hammer, fit the pin into the plate to avoid movement or vibration;

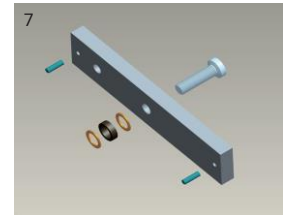

7 Assemble the components as shown in the image, not forgetting the rubber washers;

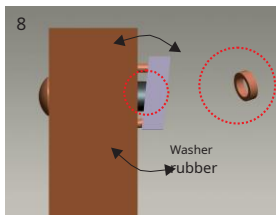

8 Place the rubber washer between the plate and the door;



9 Use the allen key to separate the plate from the body of the electromagnet;

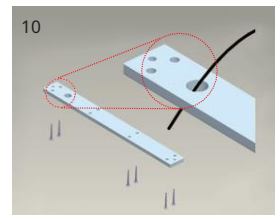

10 Fix the plate to the door frame according to the holes;

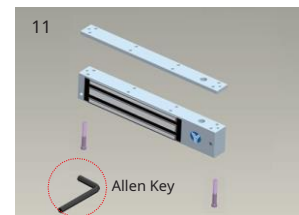

11 Use the Allen key to attach the electromagnet to the plate;

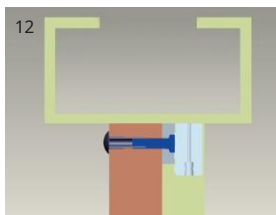

12 Close the door to test the retention force. The distance between the plate and the electromagnet can be adjusted with the washers;

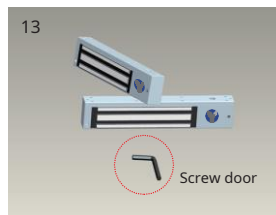

13 Fix the anti-vandalism screw;

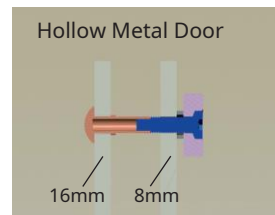

Hollow Metal Door

16mm 8mm

Make a hole with the measurements

Interior Door: 8 mm

Exterior Door: 16 mm

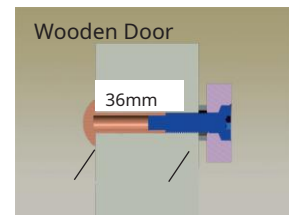

Wooden Door

36mm 8mm

Make a hole with the measurements

Interior Door: 8 mm

Exterior Door: 12.7 mm

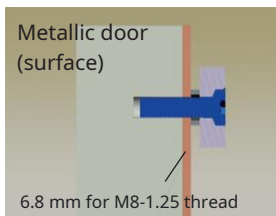

Metallic door (surface)

6.8 mm for M8-1.25 thread

Interior Door: Drill an 8mm hole

### ! Notice:

Door thickness

350LBS: 44mm 600LBS: 50mm 800LBS: 48mm 1200LBS: 46mm

A. The armor plate screw should not be too tight, as this may damage the rubber washer. The washer should have enough elasticity to ensure the plate is properly adjusted.

B. Check whether the required current is 12VDC or 24VDC.

We have several bracket models available for the desired door (wood, metal, glass) and the type of opening (single or double leaf door).

### "L" Square

Required when the door thickness is greater than 42mm.



Square for single door

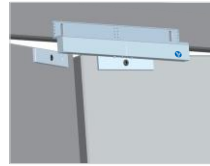

Double door square

### Protection Squadron

Ideal for protecting and hiding electrical wires. A single piece that overlaps the electromagnet.



Square for single door



Double door square

### "ZL" Square

Required for inward-opening doors.



Square for single door

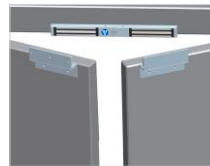

Double door square

### Protection Square – doors with inward openings.

Ideal for protecting and hiding electrical wires. A single piece that overlaps the electromagnet.



Square for single door

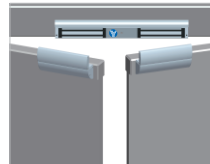

Double door square

### "GZ" Square

One-piece, durable material with a professional appearance, easy to install and suitable for 10-15mm frameless glass doors

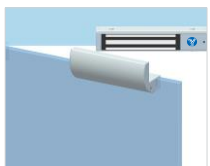

Square for single door

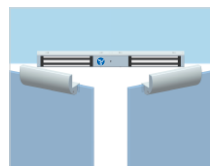

Double door square

### Fixing Sleeve – "U" Square

For glass doors 10 to 12 mm thick

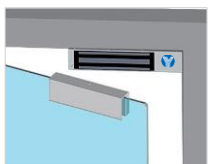

### Extension Square

For doors with greater thickness, in conjunction with the "L" square



## Wiring diagram

12VDC

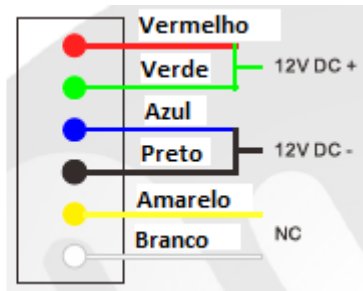

## Special features

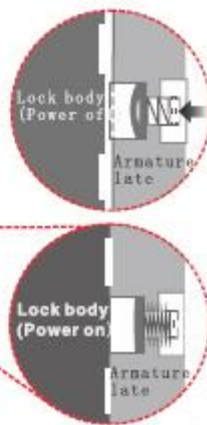
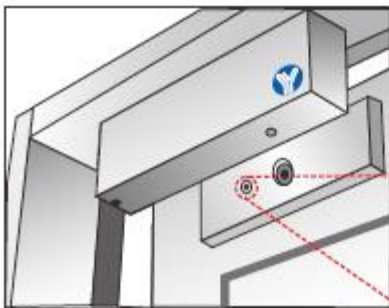

Designed to resist residual magnetism after a power outage. Tested to open quickly even after 500,000 attempts.



Added strings of safety features at the ends of the lock and counterplate. When attached, one end to the lock and the other end to the door, they provide greater fall protection.